



亮舟照明，船舶之光
Liangzhou Lighting, light of ships.



2019 亮舟灯具

LED灯具系列产品手册

上海亮舟灯具制造有限公司
SHANGHAI LIANGZHOU LAMP MANUFACTURE CO.,LTD

地址 Add : 上海市奉贤区奉城镇奉旺路69号
No.69, Fengwang Road, Fengcheng
Town, Fengxian Zone, Shanghai

邮编 Zip code : 201411
网址 Http : www.liangzhoudq.com

电话 Tel : 86-21-57510506/57512908 (国内)
86-21-57511090/57511130 (国内)
86-21-57510300(Export)

传真 Fax : 86-21-57510690
Email : shanghailiangzhou@163.com

中国·上海

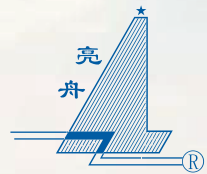

公司简介 COMPANY INTRODUCTION

上海亮舟灯具制造有限公司属(国内合资)有限责任公司。公司成立于2000年11月,注册资本为1500万元人民币。

公司是一家船用灯具专业制造商,集设计研发、生产制造、销售服务于一体的企业。迄今为止,基本覆盖为国内中大型造船厂作整船灯具配套,并出口到欧洲,中东,东南亚,产品受到国际客商的广泛好评,销量亦是逐年递增。主要生产船舶用LED灯具系列,航行信号灯系列,舱顶灯系列,蓬顶灯系列,白炽灯系列,投光灯系列,防爆灯系列,及船用接插件系列。

公司位于上海市奉贤区奉城镇,公司占地面积1.2万平方米,建筑面积1.1万多平方米。现有员工190多人,其中专业技术人员35人。公司拥有雄厚的技术力量,齐全的生产设施,先进的制造工艺,严密的检测手段和科学的管理体系,先后于2003年通过ISO9001质量管理体系认证,2004年通过中国船级社产品型式认可,2008年通过法国船级社工厂认可,2013年通过中华人民共和国渔业船舶检验局产品型式认可及欧盟CE产品认证,2016年通过欧盟(ATEX)防爆体系BS EN ISO/IEC 80079-34:2011以及通过俄罗斯船级社RS产品型式认可。

公司生产厂区设有冲压车间,金加工车间,塑料成

型车间,喷涂车间,总装车间等生产车间;并于2013年在江苏常州市金坛区朱林工业开发区投资创建江苏亮舟防爆电气有限公司,现占地面积4.7万平方米,建筑面积1.5万平方米,主要采用硅熔胶工艺,水玻璃工艺用于生产配套“亮舟”品牌的照明灯具,防爆灯具,铜质接插件等壳体铸件。

公司一直坚持“精心管理,精益生产,持续改进,用户满意”的质量方针,在船舶照明领域积累了丰富的行业经验,以专业的技术,认真务实的工作态度,致力于为用户提供更好的产品及最佳的服务而努力。

Shanghai Liangzhou Lamp Manufacture Co., Ltd. is (joint venture) limited liability company. Founded in November 2000, the registered capital of 15 million yuan.

Our company is a professional manufacturer of marine lights, Set design and development of production and sales services in one enterprise. Up to now, the basic coverage for the domestic large and medium-sized shipyards for the whole ship lights matching, and exported to Europe, the Middle East, Southeast Asia market, the product has been widely praised by international customers, sales are also increasing year by year. Our main products is LED series lights, including navigation signal light series, pendant light series, ceiling lights series, Incandescent lights, spot lights series, explosion proof light series and electric connectors and so on.

The company is located in fengcheng town, fengxian district, Shanghai City. the company covers an area of 12000 m², construction area of more than 11000 m². Existing staff of more than 190 workers, including professional and technical personnel of 35 persons. The company has strong technical force, complete production facilities, advanced manufacturing technology, strict testing means and scientific management system, we passed the ISO9001 quality management system certification in 2013, passed type approval by CCS(China's classification Society) in 2004, passed factory approval by BV(Bureau Veritas) in 2008, passed type approval of production by the People's Republic of China fishing vessel inspection bureau and European CE product certification in 2013, passed by the European Union (ATEX) BS EN ISO/IEC and 80079-34:2011 explosion-proof system, passed product type approval of the Russian

society of RS in 2016.

The company production factory is equipped with stamping workshop, machining workshop, plastic molding workshop, painting workshop, assembly workshop and other production workshop; In 2013, our company set up Jiangsu Liangzhou explosion-proof electrical limited company in Zhulin Industrial Development Zone, Jintan District, Changzhou City, Jiangsu Province, covers an area of 47000 m², construction area of 15000 m², the main production of silicon sol technology, water glass for supporting the production of "Liangzhou" brand lighting, like the body of explosion-proof lamps, copper connectors and other castings.

The company has been adhering to the "careful management, lean production, continuous improvement, customer satisfaction, quality policy" in the field of ship lighting has accumulated a rich experience in the industry, with professional technology, serious and pragmatic work attitude, is committed to providing better products and the best service for customers.



目录 CONTENTS

LED 舱顶灯 LED pendant light	01
1.LCCD2-1-2	02
2.CCD4-1	03
2.CCD9-5 CCD9-6	04
3.LCCD9-5 LCCD9-6	05
4.WB-2	06
5.DS7-2M	07
6.LZYC20-2 LZYC40-2	08
7.LZYC22-2 LZYC42-2	09
8.LZYC23-2 LZYC43-2	10
9.LZYC24-2 LZYC44-2	11
10.LZYC25-2 LZYC45-2	12
11.LZYC26-2 LZYC46-2	13
12.LZYC27-2	14
13.LZYC28-2 LZYC48-2	15
14.LZYC29/49	16
LED 蓬顶灯 LED ceiling light	17
1.LZYP20/40	18
2.LZYP22-2	19
3.LZYP23-2	20
4.LZYP24-2	21
5.LZYP25-2 LZYP45-2	22
6.LZYP26-2	23
7.LZYP27-2 LZYP47-2	24
8.LZYP28-2 LZYP48-2	25
9.LZYP29-2 LZYP49-2	26
10.LZYP2620 LZYP2640	27
LED 筒灯 LED Barrel light	28
1. JXQ-1L JXQ-2L JXQ-3L	28
LED 角灯 LED Corner light	29
1.LZYB17-E LZYP17-F	30
2.LZYB20-1/E	31
3.LZYB22-1/E	32
4.LZYB22-2/E	33

LED 防爆灯 LED explosion-proof light	34
1.CFD2a	35
2.CFD3	36
3.CFD5	37
4.CFT3	38
5.CFY20-2/40-2LT/LB	39
6.CFYD20/40-2LT	40

LED 投光灯 LED flood light	41
1.LTG15-60/100	42
2.LTG15B-150/200	43
3.LTG15B-250/300	44
4.TZ4-300	45

LED 辅助照明 Auxiliary lighting	46
1.LED 壁灯 CBD2/CBD4/CBD5	47
2.LED 床头灯 CKS3	48
3.LED 床头灯 CKS4	49
4.LED 床头灯 LZYT08-1	50
5.LED 台灯 CTD3	51
6.LED 台灯 CTD8	52
7.LED 台灯 CTD9	53

亮舟与您携手共进
LET' S JOIN HANDS TOGETHER

LED 舱顶灯
LED pendant light

LED 舱顶灯
LED pendant light

LED 舱顶灯
LED pendant light



- ▶ **适用范围：**
该灯具适用于各类船舶中的甲板、走道等潮湿场所或舱室中使用。
- ▶ **产品特性：**
1. 灯具结构简单，防水性能良好。电缆外径 $\Phi 10 \sim \Phi 14\text{mm}$ 。
2. 采用 LED 光源模块，高光效，使用寿命长。
- ▶ **采用标准及产品认证：**
符合国际 IEC60598-1-2008 标准；符合《钢质海船入级规范》；

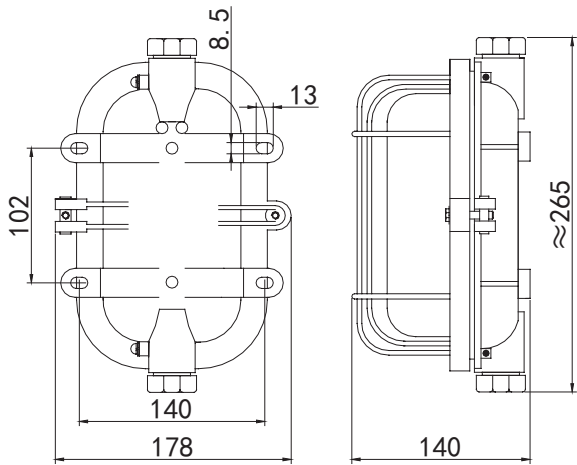

LCCD2-1-2

- ▶ **The scope of application:**
Applied to the illumination for deck,side walk and wet places or cabin of ships.
- ▶ **Products feature:**
1.The structure of light is simple,has good waterproof function. Cable outside diameter $\Phi 10 \sim \Phi 14\text{mm}$.
2.Adopt LED module,high photosynthetic efficiency,long lifetime.
- ▶ **Adopt standard and products certification:**
Conform to INTERNATIONAL STANDARD IEC60598-1-2008,Conform to GRADE ENTRY NORMS FOR STEEL SHIPS.

型号 Type	LCCD2-1-2
颜色 Color	磨砂、乳白 Frosted、Opal
电压 Voltage (V)	AC220-240V
光源 Light source	LED driver+LED chips
功率 Power(W)	8W
光通量 (LM)	550LM
材质 Material	铝 Aluminum
防护等级 Protection class	IP56
重量 Weight(Kg)	2.2



- ▶ **适用范围：**
该灯具适用于各类船舶中的甲板、走道等潮湿场所或舱室中使用。
- ▶ **产品特性：**
1. 灯具结构简单，防水性能良好。电缆外径 $\Phi 10 \sim \Phi 14\text{mm}$ 。
2. 采用 LED 球泡，寿命长，并且更换方便。
- ▶ **采用标准及产品认证：**
符合国际 IEC60598-1-2008 标准；符合《钢质海船入级规范》；；CCD4-1 通过中国船级社 (CCS) 型式认可。通过俄罗斯船级社 RMRS 型式认可证书。

- ▶ **The scope of application:**
Applied to the illumination for deck,side walk and wet places or cabin of ships.
- ▶ **Products feature:**
1.The structure of light is simple,has good waterproof function. Cable outside diameter $\Phi 10 \sim \Phi 14\text{mm}$.
2.Adopt LED bulbs,long lifetime and easily to replace.
- ▶ **Adopt standard and products certification:**
Conform to INTERNATIONAL STANDARD IEC60598-1-2008,Conform to GRADE ENTRY NORMS FOR STEEL SHIPS. CCD4-1 approved by type approval of China Classification Society(CCS) .Approved by type approval of RMRS .

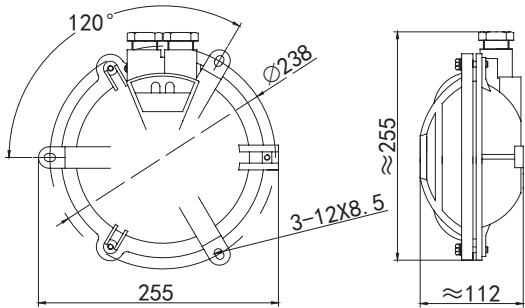

CCD4-1

型号 Type	CCD4-1	
颜色 Color	透明、磨砂、乳白 Transparent、Frosted、Opal	
电压 Voltage (V)	AC220-240V	
光源 Light source	LED 球泡 LED BULBS	
功率 Power(W)	9W	
灯座 Lamp holder	E27	
材质 Material	铜 Brass	铝 Aluminum
防护等级 Protection class	IP56	
重量 Weight(Kg)	4.1	1.7

LED 舱顶灯
LED pendant light

LED 舱顶灯
LED pendant light

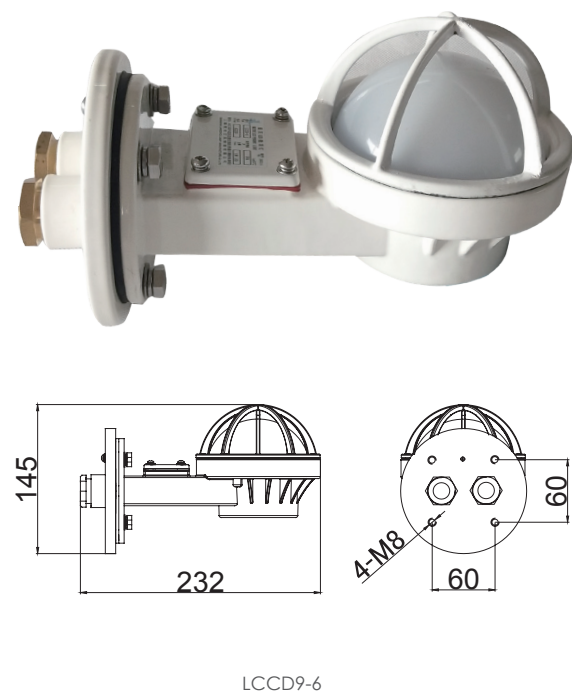
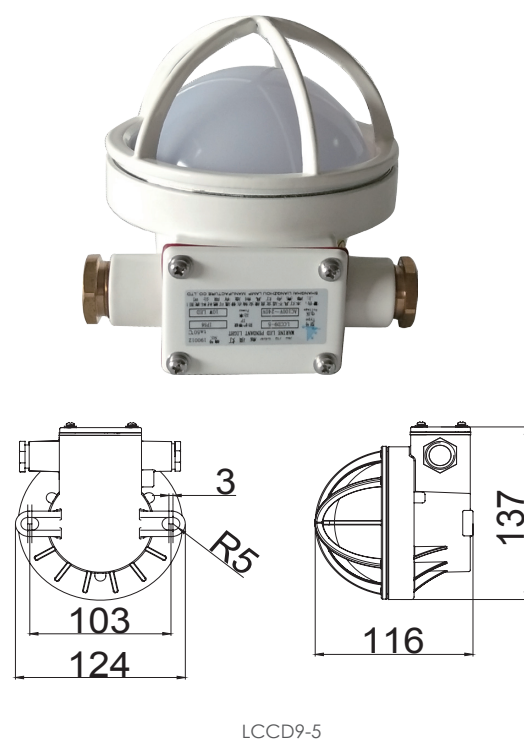
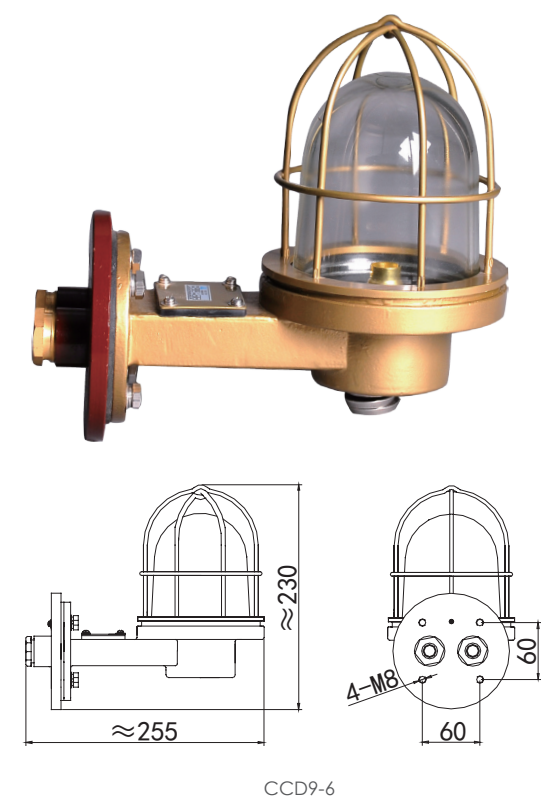
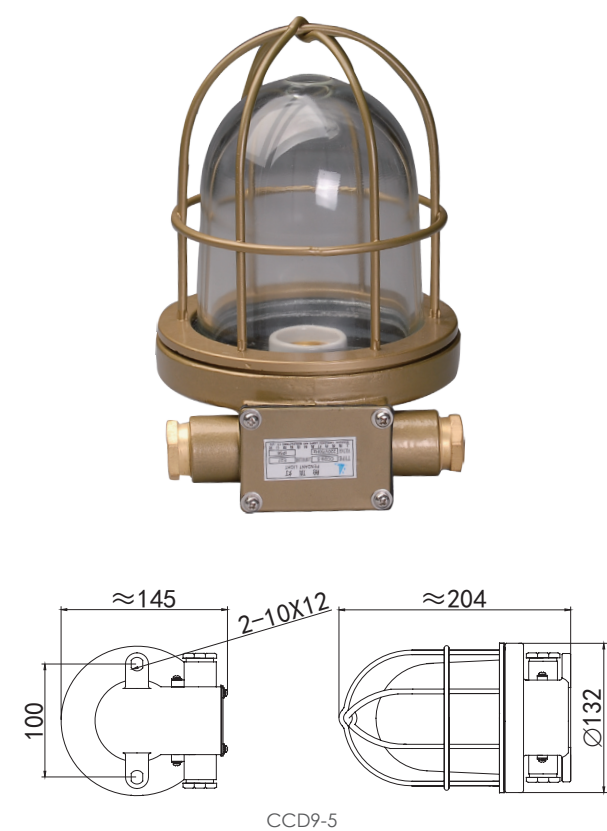

- **适用范围：**
该灯具适用于各类船舶中的甲板、走道等潮湿场所或舱室中使用。
- **产品特性：**
1. 灯具结构简单，防水性能良好。电缆外径 Φ10 ~ Φ14mm。
2. 采用 LED 球泡，寿命长，并且更换方便。
- **采用标准及产品认证：**
符合国际 IEC60598-1-2008 标准；符合《钢质海船入级规范》，通过中国船级社 (CCS) 型式认可。

- **The scope of application:**
Applied to the illumination for deck,side walk and wet places or cabin of ships.
- **Products feature:**
1.The structure of light is simple,has good waterproof function. Cable outside diameter Φ10 ~ Φ14mm.
2.Adopt LED bulbs,long lifetime and easily to replace.
- **Adopt standard and products certification:**
Conform to INTERNATIONAL STANDARD IEC60598-1-2008 .Conform to GRADE ENTRY NORMS FOR STEEL SHIPS.Approved by type approval of China Classification Society(CCS)

型号 Type	CCD9-5	CCD9-6
颜色 Color	透明、磨砂、乳白、红、绿、蓝、黄 Transparent、Frosted、Opal、Red Green、Blue、Yellow	
电压 Voltage (V)	AC220-240	
光源 Light source	LED 球泡 LED BULBS	
功率 Power(W)	9W	9W
灯座 Lamp holder	E27	
材质 Material	铜 Brass	
防护等级 Protection class	IP56	
重 量 Weight(Kg)	1.9	3.5

- **The scope of application:**
Applied to the illumination for deck,side walk and wet places or cabin of ships.
- **Products feature:**
1.The structure of light is simple,has good waterproof function. Cable outside diameter Φ10 ~ Φ12mm.
2.LED module light source,long service life, high light intensity, low energy consumption.
- **Adopt standard and products certification:**
Conform to INTERNATIONAL STANDARD IEC60598-1-2008 .Conform to GRADE ENTRY NORMS FOR STEEL SHIPS.Approved by type approval of China Classification Society(CCS) .

- **适用范围：**
该灯具适用于各类船舶中的甲板、走道等潮湿场所或舱室中使用。
- **产品特性：**
1. 灯具结构简单，防水性能良好。电缆外径 Φ10 ~ Φ12mm。
2. 采用 LED 光源模块，使用寿命长，高光效，能耗低。
- **采用标准及产品认证：**
符合国际 IEC60598-1-2008 标准；符合《钢质海船入级规范》；通过中国船级社 (CCS) 型式认可。

型号 Type	LCCD9-5	LCCD9-5A	LCCD9-6	LCCD9-6A
颜色 Color	乳白 Opal			
电压 Voltage (V)	AC.100V ~ 240V(50Hz/60Hz)	DC24V	AC.100V ~ 240V(50Hz/60Hz)	DC24V
光源 Light source	LED 电源 +LED 光源 LED Driver+ LED chips			
功率 Power(W)	10W			
灯座 Lamp holder	800LM			
材质 Material	铜 Brass/ 不锈钢 stainless steel			
防护等级 Protection class	IP56			
重 量 Weight(Kg)	1.9	1.9	3.5	3.5

LED 舱顶灯
LED pendant light

- 适用范围：
- 该灯具适用于各类船舶有滴水、溅水、凝水和露天场所，如机炉舱、干货舱、管弄、露天甲板等处照明用。
- 产品特性：
1. 灯体用合成树脂注塑成型，造型美观，壁式安装。
2. 采用 LED 球泡，寿命长，并且更换方便。
- 采用标准：
1. 符合 GB7000.201 标准。
2. 符合 GB7000.1 标准。
3. 符合《钢质海船入级规范》。
4. 采用日本 JISF8414-2003 标准组织生产。



- The scope of application:
- This series of lights fit for illumination for the ships with water dripping,water spattering,water coagulating and weather place,such as oven cabin,dry cabin,pipe tunnel and weather deck etc.
- Products feature:
- 1.The light body adopts synthetic resin by injection molding,nice shape,Wall-type mounting.
- 2.Adopt LED bulbs,long lifetime and easily to replace.
- Adopt standard:
- 1.Conform to GB7000.201 standard.
- 2.Conform to GB7000.1 standard.
3. Conform to GRADE ENTRY NORMS FOR STEEL SHIPS.
- 4.Adopt the Japanese JISF8414-2003 standard organization of production .

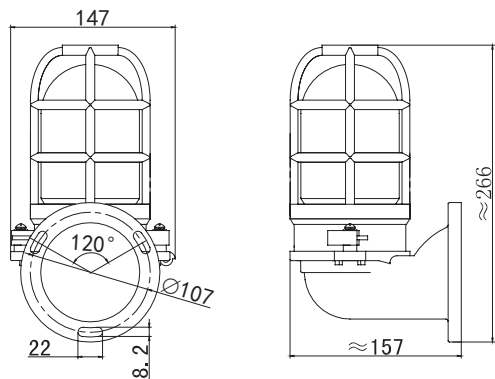

WB-2

型号 Type	WB-2
国际代码 Code	792068
电压 Voltage (V)	AC220-240V
灯座 Lamp holder	FE26
光源 / 功率 Light source/Power	LED 球泡 LED BULBS 9W
颜 色 Color	明 Transparent, 红 Red, 绿 Green, 蓝 Blue, 黄 Yellow
防护等级 Protection class	IP56
重 量 Weight(Kg)	1.1

LED 舱顶灯
LED pendant light

- 适用范围：
- 该灯具适用于各类船舶有滴水、溅水、凝水和露天场所，如机炉舱、干货舱、管弄、露天甲板等处照明用。
- 产品特性：
1. 灯体用合成树脂注塑成型，造型美观，吸顶式安装。
2. 采用 LED 球泡，寿命长，并且更换方便。
- 采用标准：
1. 符合 GB7000.201 标准。
2. 符合 GB7000.1 标准。
3. 符合《钢质海船入级规范》。
4. 采用日本 JISF8414-2003 标准组织生产。



- The scope of application:
- This series of lights fit for illumination for the ships with water dripping,water spattering,water coagulating and weather place,such as oven cabin,dry cabin,pipe tunnel and weather deck etc.
- Products feature:
- 1.The light body adopts synthetic resin by injection molding,nice shape,Ceiling type mounting.
- 2.Adopt LED bulbs,long lifetime and easily to replace.
- Adopt standard:
- 1.Conform to GB7000.201 standard.
- 2.Conform to GB7000.1 standard.
3. Conform to GRADE ENTRY NORMS FOR STEEL SHIPS.
- 4.Adopt the Japanese JISF8414-2003 standard organization of production .

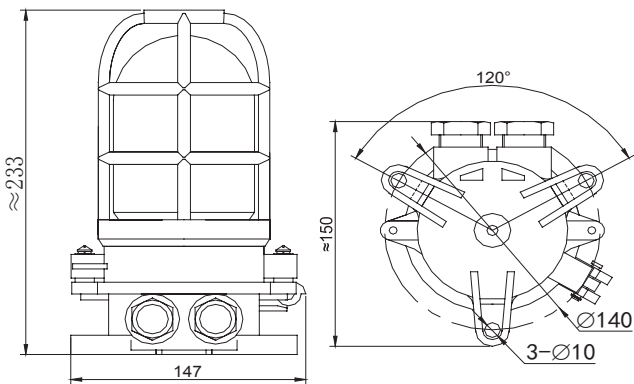

DS7-2M

型号 Type	DS7-2M
国际代码 Code	792057
电压 Voltage (V)	AC220-240V
灯座 Lamp holder	FE26
光源 / 功率 Light source/Power	LED 球泡 LED BULBS 9W
颜 色 Color	明 Transparent, 红 Red, 绿 Green, 蓝 Blue, 黄 Yellow
防护等级 Protection class	IP56
重 量 Weight(Kg)	1.0

LED 舱顶灯
LED pendant light

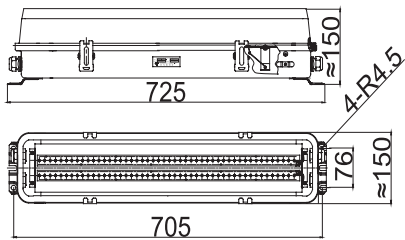

LZYC20-2

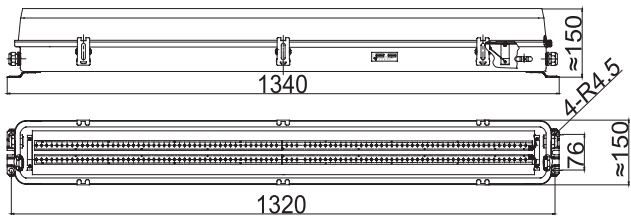

LZYC40-2

► 适用范围：

该灯具适用于各类船舶有滴水、溅水和凝水（如露天甲板、机炉舱、干货舱、轴隧、管弄、外走道）等场所照明之用。

► 产品特性：

1. 灯壳采用优质冷轧镀锌板拉伸成型，表面经过白色防酸环氧聚酯粉末喷涂处理。
2. 灯罩采用透明抗冲击聚碳酸脂注塑成型，灯罩密封圈采用发泡硅橡胶，密封性能良好。
3. 为保证用电安全，灯具内外均装有带“⊕”的接线桥架。
4. 采用 LED 光源，使用寿命长，光强度高，能耗低。
5. 灯具可配置 3W 应急 LED 光源，作为断电时临时照明。配置应急光源的灯具，其灯罩上带有小红点标志。
6. 电缆外径 $\Phi 10 \sim \Phi 14\text{mm}$ 。

► 采用标准及产品认证：

1. 符合国际 IEC60598-1-2008 标准
2. 符合《钢质海船入级规范》
3. 通过中国船级社 (CCS) 型式认可。
4. 通过俄罗斯船级社 RMRS 型式认可证书。

► The scope of application:

This series of lights fit for illumination for the places of ships with water dripping,water spattering,water coagulating(such as weather place,such as oven cabin,dry cabin,tunnel,pipeline and weather deck etc.).

► Products feature:

- 1.The shell adopts good quality cold-rolled zinc galvanized plate by mold pressing , Body surface is powder coated after anti-acid white.
- 2.The lampshade is made of transparent impact resistant poly carbonate plastic by injection forming, Lampshade seal-ring use foamed silicone rubber, with good sealed performance.
- 3.In order to ensure the safety of electricity, both inside and outside of lamps is equipped with "⊕" connection bridge.
- 4.Adopt LED light source, long service life, high intensity, low energy consumption.
- 5.This light can be equipped with 3W LED emergency light source, as temporary lighting when power off. With emergency lamp holder lights,on the lampshade with a red remark.
- 6.Cable outside diameter $\Phi 10 \sim \Phi 14\text{ mm}$.

► Adopt standard and products certification:

- 1.Conform to IEC60598-1-2008 INTERNATIONAL STANDARD.
- 2.Conform to GRADE ENTRY NORMS FOR STEEL SHIPS.
- 3.Approved by type approval of China Classification Society(CCS).
- 4.Approved by type approval of RMRS .

型号 TYPE	LZYC20-2	LZYC20-2E	LZYC20-2G	LZYC40-2	LZYC40-2E	LZYC40-2G
功率 (W) power	2X8W	2X8W+3W	2X8W	2X16W	2X16W+3W	2X16W
电压 / 频率 Voltage/frequency	AC100-240V 50/60HZ					
光源 Light source	LED 电源 +LED 灯条 LED Driver+ LED chips					
光通量 LM	1600LM	1600LM	1600LM	3200LM	3200LM	3200LM
蓄电池放电时间 Battery emergency working time			≥ 180Min			≥ 180Min
防护等级 Protection class	IP66					
重 量 (Kg) Weight	5.0	5.2	6.5	9.0	9.2	10.5

LED 舱顶灯
LED pendant light

► 适用范围：

该灯具适用于各类船舶有滴水、溅水和凝水（如露天甲板、机炉舱、干货舱、轴隧、管弄、外走道）等场所照明之用。

► 产品特性：

1. 灯壳采用优质冷轧镀锌板拉伸成型，表面经过白色防酸环氧聚酯粉末喷涂处理。
2. 灯罩采用透明抗冲击聚碳酸脂注塑成型，灯罩密封圈采用发泡硅橡胶，密封性能良好。
3. 为保证用电安全，灯具内外均装有带“⊕”的接线桥架。
4. 采用 LED 光源，使用寿命长，光强度高，能耗低。
5. 灯具可配置 3W 应急 LED 光源，作为断电时临时照明。配置应急光源的灯具，其灯罩上带有小红点标志。
6. 电缆外径 $\Phi 10 \sim \Phi 14\text{mm}$ 。

► 采用标准及产品认证：

1. 符合国际 IEC60598-1-2008 标准
2. 符合《钢质海船入级规范》
3. 通过中国船级社 (CCS) 型式认可。
4. 通过俄罗斯船级社 RMRS 型式认可证书。

► The scope of application:

This series of lights fit for illumination for the places of ships with water dripping,water spattering,water coagulating(such as weather place,such as oven cabin,dry cabin,tunnel,pipeline and weather deck etc.).

► Products feature:

- 1.The shell adopts good quality cold-rolled zinc galvanized plate by mold pressing ,Body surface is powder coated after anti-acid white.
- 2.The lampshade is made of transparent impact resistant poly carbonate plastic by injection forming, Lampshade seal-ring use foamed silicone rubber, with good sealed performance.
- 3.In order to ensure the safety of electricity, both inside and outside of lamps is equipped with "⊕" connection bridge.
- 4.Adopt LED light source, long service life, high intensity, low energy consumption.
- 5.This light can be equipped with 3W LED emergency light source, as temporary lighting when power off. With emergency lamp holder lights,on the lampshade with a red remark.
- 6.Cable outside diameter $\Phi 10 \sim \Phi 14\text{ mm}$.

► Adopt standard and products certification:

- 1.Conform to IEC60598-1-2008 INTERNATIONAL STANDARD.
- 2.Conform to GRADE ENTRY NORMS FOR STEEL SHIPS.
- 3.Approved by type approval of China Classification Society(CCS).
- 4.Approved by type approval of RMRS .

型号 TYPE	LZYC22-2	LZYC22-2E	LZYC22-2F	LZYC22-2G	LZYC42-2	LZYC42-2E	LZYC42-2F	LZYC42-2G
功率 (W) power	2X8W	2X8W+3W	2X8W	2X8W	2X16W	2X16W+3W	2X16W	2X16W
电压 / 频率 Voltage/frequency	AC100-240V 50/60HZ							
光源 Light source	LED 电源 +LED 灯条 LED Driver+ LED chips							
光通量 LM	1600LM	1600LM	1600LM	1600LM	3200LM	3200LM	3200LM	3200LM
蓄电池放电时间 Battery emergency working time				≥ 180Min				≥ 180Min
防护等级 Protection class	IP66							
重 量 (Kg) Weight	5.4	5.6	6.6	6.9	8.5	8.7	9.9	10.3

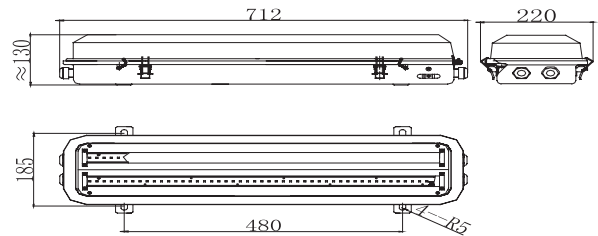

LZYC22-2

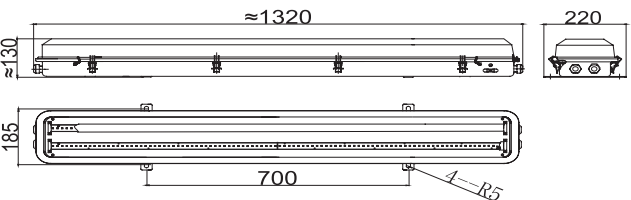

LZYC42-2

LED 舱顶灯
LED pendant light

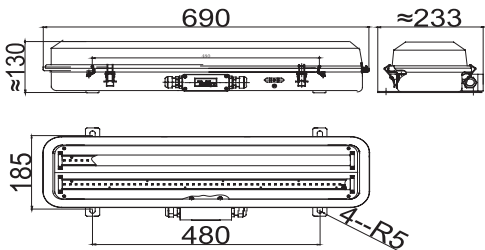

LZYC23-2

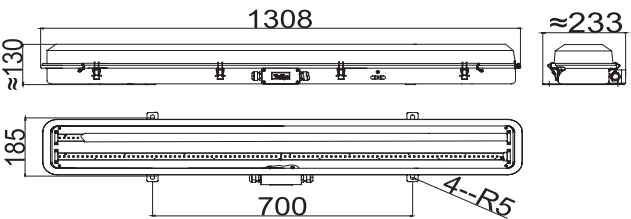

LZYC43-2

► 适用范围：

该灯具适用于各类船舶有滴水、溅水和凝水（如露天甲板、机炉舱、干货舱、轴隧、管弄、外走道）等场所照明之用。

► 产品特性：

1. 灯壳采用优质冷轧镀锌板拉伸成型，表面经过白色防酸环氧聚酯粉末喷涂处理。
2. 灯罩采用透明抗冲击聚碳酸脂注塑成型，灯罩密封圈采用发泡硅橡胶，密封性能良好。
3. 为保证用电安全，灯具内外均装有带“⊕”的接线桥架。
4. 采用 LED 光源，使用寿命长，光强高，能耗低。
5. 灯具可配置 3W 应急 LED 光源，作为断电时临时照明。配置应急光源的灯具，其灯罩上带有小红点标志。
6. 电缆外径 $\Phi 10 \sim \Phi 14\text{mm}$ 。

► 采用标准及产品认证：

1. 符合国际 IEC60598-1-2008 标准
2. 符合《钢质海船入级规范》
3. 通过中国船级社 (CCS) 型式认可。
4. 通过俄罗斯船级社 RMRS 型式认可证书。

► The scope of application:

This series of lights fit for illumination for the places of ships with water dripping,water spattering,water coagulating(such as weather place,such as oven cabin,dry cabin,tunnel,pipeline and weather deck etc.).

► Products feature:

- 1.The shell adopts good quality cold-rolled zinc galvanized plate by mold pressing ,Body surface is powder coated after anti-acid white.
- 2.The lampshade is made of transparent impact resistant poly carbonate plastic by injection forming, Lampshade seal-ring use foamed silicone rubber, with good sealed performance.
- 3.In order to ensure the safety of electricity, both inside and outside of lamps is equipped with "⊕" connection bridge.
- 4.Adopt LED light source, long service life, high intensity, low energy consumption.
- 5.This light can be equipped with 3W LED emergency light source, as temporary lighting when power off. With emergency lamp holder lights,on the lampshade with a red remark.
- 6.Cable outside diameter $\Phi 10 \sim \Phi 14\text{ mm}$.

► Adopt standard and products certification:

- 1.Conform to IEC60598-1-2008 INTERNATIONAL STANDARD.
- 2.Conform to GRADE ENTRY NORMS FOR STEEL SHIPS.
- 3.Approved by type approval of China Classification Society(CCS).
- 4.Approved by type approval of RMRS .

型号 TYPE	LZYC23-2	LZYC23-2E	LZYC23-2F	LZYC23-2G	LZYC43-2	LZYC43-2E	LZYC43-2F	LZYC43-2G
功率 (W) power	2X8W	2X8W+3W	2X8W	2X8W	2X16W	2X16W+3W	2X16W	2X16W
电压 / 频率 Voltage/frequency	AC100-240V 50/60HZ							
光源 Light source	LED 电源 +LED 灯条 LED Driver+ LED chips							
光通量 LM	1600LM	1600LM	1600LM	1600LM	3200LM	3200LM	3200LM	3200LM
蓄电池放电时间 Battery emergency working time				≥ 180Min				≥ 180Min
防护等级 Protection class	IP66							
重 量 (Kg) Weight	5.4	5.6	6.0	6.2	8.6	8.7	9.5	10.1

LED 舱顶灯
LED pendant light

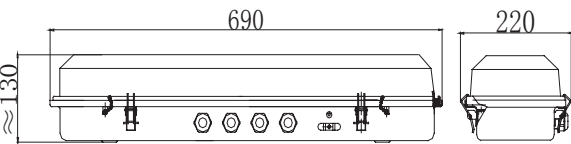

LZYC24-2

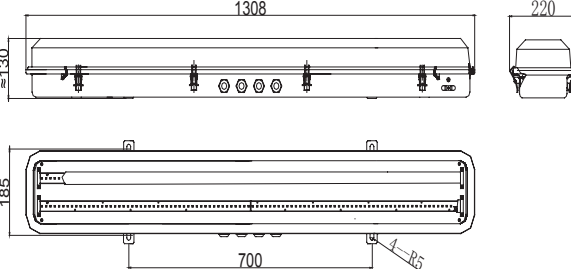

LZYC44-2

► 适用范围：

该灯具适用于各类船舶有滴水、溅水和凝水（如露天甲板、机炉舱、干货舱、轴隧、管弄、外走道）等场所照明之用。

► 产品特性：

1. 灯壳采用优质冷轧镀锌板拉伸成型，表面经过白色防酸环氧聚酯粉末喷涂处理。
2. 灯罩采用透明抗冲击聚碳酸脂注塑成型，灯罩密封圈采用发泡硅橡胶，密封性能良好。
3. 为保证用电安全，灯具内外均装有带“⊕”的接线桥架。
4. 采用 LED 光源，使用寿命长，光强高，能耗低。
5. 灯具可配置 3W 应急 LED 光源，作为断电时临时照明。配置应急光源的灯具，其灯罩上带有小红点标志。
6. 电缆外径 $\Phi 10 \sim \Phi 14\text{mm}$ 。

► 采用标准及产品认证：

1. 符合国际 IEC60598-1-2008 标准
2. 符合《钢质海船入级规范》
3. 通过中国船级社 (CCS) 型式认可。
4. 通过俄罗斯船级社 RMRS 型式认可证书。

► The scope of application:

This series of lights fit for illumination for the places of ships with water dripping,water spattering,water coagulating(such as weather place,such as oven cabin,dry cabin,tunnel,pipeline and weather deck etc.).

► Products feature:

- 1.The shell adopts good quality cold-rolled zinc galvanized plate by mold pressing ,Body surface is powder coated after anti-acid white.
- 2.The lampshade is made of transparent impact resistant poly carbonate plastic by injection forming, Lampshade seal-ring use foamed silicone rubber, with good sealed performance.
- 3.In order to ensure the safety of electricity, both inside and outside of lamps is equipped with "⊕" connection bridge.
- 4.Adopt LED light source, long service life, high intensity, low energy consumption.
- 5.This light can be equipped with 3W LED emergency light source, as temporary lighting when power off. With emergency lamp holder lights,on the lampshade with a red remark.
- 6.Cable outside diameter $\Phi 10 \sim \Phi 14\text{ mm}$.

► Adopt standard and products certification:

- 1.Conform to IEC60598-1-2008 INTERNATIONAL STANDARD.
- 2.Conform to GRADE ENTRY NORMS FOR STEEL SHIPS.
- 3.Approved by type approval of China Classification Society(CCS).
- 4.Approved by type approval of RMRS .

型号 TYPE	LZYC24-2	LZYC24-2E	LZYC24-2F	LZYC24-2G	LZYC44-2	LZYC44-2E	LZYC44-2F	LZYC44-2G
功率 (W) power	2X8W	2X8W+3W	2X8W	2X8W	2X16W	2X16W+3W	2X16W	2X16W
电压 / 频率 Voltage/frequency	AC100-240V 50/60HZ							
光源 Light source	LED 电源 +LED 灯条 LED Driver+ LED chips							
光通量 LM	1600LM	1600LM	1600LM	1600LM	3200LM	3200LM	3200LM	3200LM
蓄电池放电时间 Battery emergency working time				≥ 180Min				≥ 180Min
防护等级 Protection class	IP66							
重 量 (Kg) Weight	5.4	5.6	6.2	6.5	8.5	8.7	9.7	10.2

LED 舱顶灯
LED pendant light

LED 舱顶灯
LED pendant light

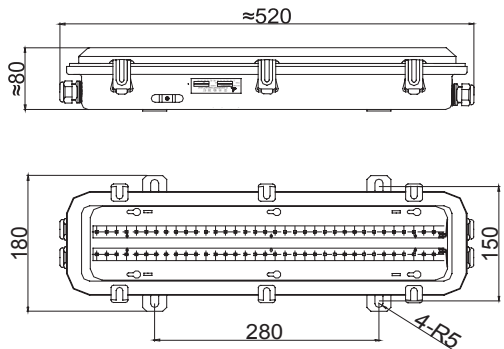

LZYC25-2

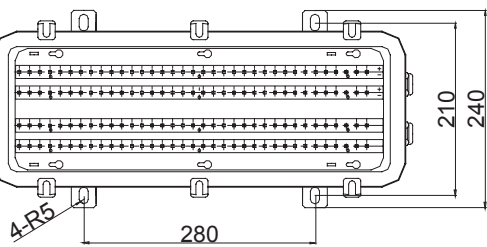
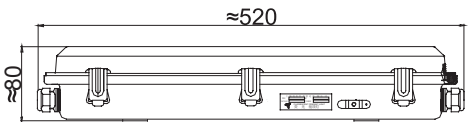

LZYC45-2

► 适用范围：

该灯具适用于各类船舶有滴水、溅水和凝水（如露天甲板、机炉舱、干货舱、轴隧、管弄、外走道）等场所照明之用。

► 产品特性：

1. 灯壳采用优质冷轧镀锌板拉伸成型，表面经过白色防酸环氧聚酯粉末喷涂处理。
2. 灯罩采用透明抗冲击聚碳酸脂注塑成型，灯罩密封圈采用发泡硅橡胶，密封性能良好。
3. 为保证用电安全，灯具内外均装有带“⊕”的接线桥架。
4. 采用 LED 光源，使用寿命长，高光效，能耗低。
5. 灯具可另配置 5W 应急 LED 电源，作为断电时应急电路照明。应急电路通电时，其中一根灯条亮。配置应急电源的灯具，其灯罩上带有小红点标志。
6. 电缆外径 $\Phi 10 \sim \Phi 14\text{mm}$ 。

► 采用标准及产品认证：

1. 符合国际 IEC60598-1-2008 标准
2. 符合《钢质海船入级规范》

► The scope of application:

This series of lights fit for illumination for the places of ships with water dripping,water spattering,water coagulating(such as weather place,such as oven cabin,dry cabin,tunnel,pipeline and weather deck etc.).

► Products feature:

- 1.The shell adopts good quality cold-rolled zinc galvanized plate by mold pressing ,Body surface is powder coated after anti-acid white.
- 2.The lampshade is made of transparent impact resistant poly carbonate plastic by injection forming, Lampshade seal-ring use foamed silicone rubber, with good sealed performance.
- 3.In order to ensure the safety of electricity, both inside and outside of lamps is equipped with "⊕" connection bridge.
- 4.Adopt LED light source, long service life, high intensity, low energy consumption.
- 5.This light can be equipped with 5W LED driver,as emergency lighting when power off. When the emergency circuit is switched on,one set chips will lighting,with emergency driver lights,on the diffuser with a red remark.
- 6.Cable outside diameter $\Phi 10 \sim \Phi 14\text{ mm}$.

► Adopt standard and products certification:

- 1.Conform to IEC60598-1-2008 INTERNATIONAL STANDARD.
- 2.Conform to GRADE ENTRY NORMS FOR STEEL SHIPS.

型号 TYPE	LZYC25-2	LZYC25-2E	LZYC25-2G	LZYC45-2	LZYC45-2E	LZYC45-2G
功率 (W) power	2X8W	2X8W+5W	2X8W	4X8W	4X8W+5W	4X8W
电压 / 频率 Voltage/frequency	AC100-240V 50/60HZ					
光源 Light source	LED 电源 +LED 灯条 LED Driver+ LED chips					
光通量 LM	1300LM	1300LM	1300LM	2600LM	2600LM	2600LM
蓄电池放电时间 Battery emergency working time			≥ 180Min			≥ 180Min
防护等级 Protection class	IP66					
重 量 (Kg) Weight						

► 适用范围：

该灯具适用于各类船舶有滴水、溅水和凝水（如露天甲板、机炉舱、干货舱、轴隧、管弄、外走道）等场所照明之用。

► 产品特性：

1. 灯壳采用优质冷轧镀锌板拉伸成型，表面经过绿色防酸环氧聚酯粉末喷涂处理。
2. 灯罩采用透明抗冲击聚碳酸脂注塑成型，灯罩密封圈采用发泡硅橡胶，密封性能良好。
3. 为保证用电安全，灯具内外均装有带“⊕”的接线桥架。
4. 采用 LED 光源，使用寿命长，光强高，能耗低。
5. 灯具可配置 3W 应急 LED 光源，作为断电时临时照明。配置应急光源的灯具，其灯罩上带有小红点标志。
6. 电缆外径 $\Phi 10 \sim \Phi 14\text{mm}$ 。

► 采用标准及产品认证：

1. 符合国际 IEC60598-1-2008 标准
2. 符合《钢质海船入级规范》
3. 通过中国船级社 (CCS) 型式认可。
4. 通过俄罗斯船级社 RMRS 型式认可证书。

► The scope of application:

This series of lights fit for illumination for the places of ships with water dripping,water spattering,water coagulating(such as weather place,such as oven cabin,dry cabin,tunnel,pipeline and weather deck etc.).

► Products feature:

- 1.The shell adopts good quality cold-rolled zinc galvanized plate by mold pressing ,Body surface is powder coated after anti-acid green.
- 2.The lampshade is made of transparent impact resistant poly carbonate plastic by injection forming, Lampshade seal-ring use foamed silicone rubber, with good sealed performance.
- 3.In order to ensure the safety of electricity, both inside and outside of lamps is equipped with "⊕" connection bridge.
- 4.Adopt LED light source, long service life, high intensity, low energy consumption.
- 5.This light can be equipped with 3W LED emergency light source, as temporary lighting when power off. With emergency lamp holder lights,on the lampshade with a red remark.
- 6.Cable outside diameter $\Phi 10 \sim \Phi 14\text{ mm}$.

► Adopt standard and products certification:

- 1.Conform to IEC60598-1-2008 INTERNATIONAL STANDARD.
- 2.Conform to GRADE ENTRY NORMS FOR STEEL SHIPS.
- 3.Approved by type approval of China Classification Society(CCS).
- 4.Approved by type approval of RMRS .

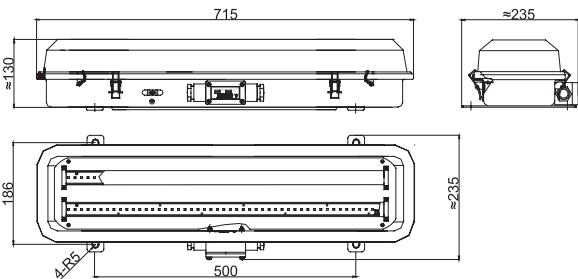

LZYC26-2

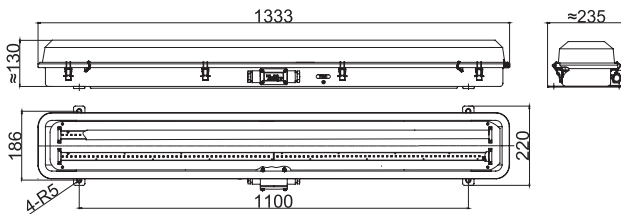

LZYC46-2

型号 TYPE	LZYC26-2	LZYC26-2E	LZYC2-2F	LZYC2-2G	LZYC46-2	LZYC46-2E	LZYC46-2F	LZYC46-2G
功率 (W) power	2X8W	2X8W+3W	2X8W	2X8W	2X16W	2X16W+3W	2X16W	2X16W
电压 / 频率 Voltage/frequency	AC100-240V 50/60HZ							
光源 Light source	LED 电源 +LED 灯条 LED Driver+ LED chips							
光通量 LM	1600LM	1600LM	1600LM	1600LM	3200LM	3200LM	3200LM	3200LM
蓄电池放电时间 Battery emergency working time				≥ 180Min				≥ 180Min
防护等级 Protection class	IP66							
重 量 (Kg) Weight	5.5	5.8	6.1	6.9	10.5	10.8	11.1	11.5

LED 舱顶灯
LED pendant light

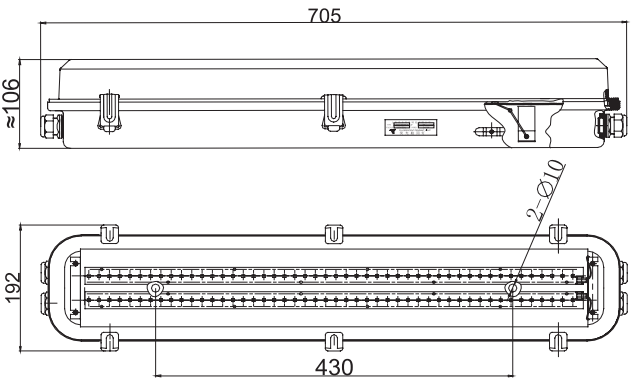

LZYC27-2

► 适用范围：

该灯具适用于各类船舶有滴水、溅水和凝水（如露天甲板、机炉舱、干货舱、轴隧、管弄、外走道）等场所照明之用。

► 产品特性：

1. 灯壳采用优质冷轧镀锌板拉伸成型，表面经过白色防酸环氧聚酯粉末喷涂处理。。
2. 灯罩采用透明抗冲击聚碳酸脂注塑成型，灯罩密封圈采用发泡硅橡胶，密封性能良好。
3. 为保证用电安全，灯具内外均装有带“⊕”的接线桥架。
4. 采用 LED 光源，使用寿命长，光强度高，能耗低。
5. 灯具可配置 3W 应急 LED 光源，作为断电时临时照明。配置应急光源的灯具，其灯罩上带有小红点标志。
6. 电缆外径 $\Phi 10 \sim \Phi 14\text{mm}$ 。

► 采用标准及产品认证：

1. 符合国际 IEC60598-1-2008 标准
2. 符合《钢质海船入级规范》
3. 通过中国船级社 (CCS) 型式认可。
4. 通过俄罗斯船级社 RMRS 型式认可证书。

► The scope of application:

This series of lights fit for illumination for the places of ships with water dripping,water spattering,water coagulating(such as weather place,such as oven cabin,dry cabin,tunnel,pipeline and weather deck etc.).

► Products feature:

- 1.The shell adopts good quality cold-rolled zinc galvanized plate by mold pressing ,Body surface is powder coated after anti-acid white.
- 2.The lampshade is made of transparent impact resistant poly carbonate plastic by injection forming, Lampshade seal-ring use foamed silicone rubber, with good sealed performance.
- 3.In order to ensure the safety of electricity, both inside and outside of lamps is equipped with "⊕" connection bridge.
- 4.Adopt LED light source, long service life, high intensity, low energy consumption.
- 5.This light can be equipped with 3W LED emergency light source, as temporary lighting when power off. With emergency lamp holder lights,on the lampshade with a red remark.
- 6.Cable outside diameter $\Phi 10 \sim \Phi 14\text{ mm}$.

► Adopt standard and products certification:

- 1.Conform to IEC60598-1-2008 INTERNATIONAL STANDARD.
- 2.Conform to GRADE ENTRY NORMS FOR STEEL SHIPS.
- 3.Approved by type approval of China Classification Society(CCS).
- 4.Approved by type approval of RMRS .

型号 TYPE	LZYC27-2	LZYC27-2E	LZYC27-2G
功率 (W) power	2X8W	2X8W+3W	2X8W
电压 / 频率 Voltage/frequency	AC100-240V 50/60HZ		
光源 Light source	LED 电源 +LED 灯条 LED Driver+ LED chips		
光通量 LM	1600LM	1600LM	1600LM
蓄电池放电时间 Battery emergency working time			≥ 180Min
防护等级 Protection class	IP66		
重 量 (Kg) Weight	5.4	5.6	6..2

LED 舱顶灯
LED pendant light

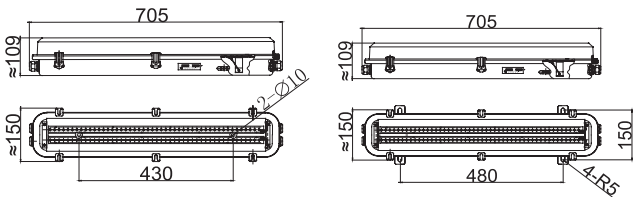

孔位安装 Hole installation LZYC28-2 桥板安装 Bridge installation

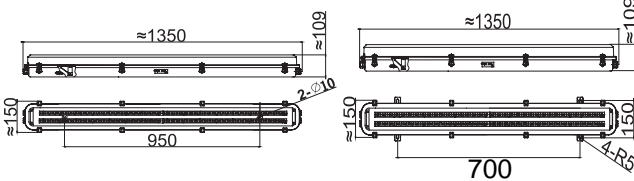

孔位安装 Hole installation LZYC48-2 桥板安装 Bridge installation

► 适用范围：

该灯具适用于各类船舶有滴水、溅水和凝水（如露天甲板、机炉舱、干货舱、轴隧、管弄、外走道）等场所照明之用。

► 产品特性：

1. 灯壳采用优质冷轧镀锌板拉伸成型，表面经过白色防酸环氧聚酯粉末喷涂处理。。
2. 灯罩采用透明抗冲击聚碳酸脂注塑成型，灯罩密封圈采用发泡硅橡胶，密封性能良好。
3. 为保证用电安全，灯具内外均装有带“⊕”的接线桥架。
4. 采用 LED 光源，使用寿命长，光强度高，能耗低。
5. 灯具可配置 DC24V/3W 应急 LED 光源，作为断电时临时照明。配置应急光源的灯具，其灯罩上带有小红点标志。
6. 电缆外径 $\Phi 10 \sim \Phi 14\text{mm}$ 。

► 采用标准及产品认证：

1. 符合国际 IEC60598-1-2008 标准
2. 符合《钢质海船入级规范》
3. 通过中国船级社 (CCS) 型式认可。
4. 通过俄罗斯船级社 RMRS 型式认可证书。

► The scope of application:

This series of lights fit for illumination for the places of ships with water dripping,water spattering,water coagulating(such as weather place,such as oven cabin,dry cabin,tunnel,pipeline and weather deck etc.).

► Products feature:

- 1.The shell adopts good quality cold-rolled zinc galvanized plate by mold pressing ,Body surface is powder coated after anti-acid white.
- 2.The lampshade is made of transparent impact resistant poly carbonate plastic by injection forming, Lampshade seal-ring use foamed silicone rubber, with good sealed performance.
- 3.In order to ensure the safety of electricity, both inside and outside of lamps is equipped with "⊕" connection bridge.
- 4.Adopt LED light source, long service life, high intensity, low energy consumption.
- 5.This light can be equipped with 3W LED emergency light source, as temporary lighting when power off. With emergency lamp holder lights,on the lampshade with a red remark.
- 6.Cable outside diameter $\Phi 10 \sim \Phi 14\text{ mm}$.

► Adopt standard and products certification:

- 1.Conform to IEC60598-1-2008 INTERNATIONAL STANDARD.
- 2.Conform to GRADE ENTRY NORMS FOR STEEL SHIPS.
- 3.Approved by type approval of China Classification Society(CCS).
- 4.Approved by type approval of RMRS .

型号 TYPE	LZYC28-2	LZYC28-2E	LZYC28-2F	LZYC28-2G	LZYC48-2	LZYC48-2E	LZYC48-2F	LZYC48-2G
功率 (W) power	2X8W	2X8W+3W	2X8W	2X8W	2X16W	2X16W+3W	2X16W	2X16W
电压 / 频率 Voltage/frequency	AC100-240V 50/60HZ							
光源 Light source	LED 电源 +LED 灯条 LED Driver+ LED chips							
光通量 LM	1600LM	1600LM	1600LM	1600LM	3200LM	3200LM	3200LM	3200LM
蓄电池放电时间 Battery emergency working time				≥ 180Min				≥ 180Min
防护等级 Protection class	IP66							
重 量 (Kg) Weight	4.3	4.5	4.8	5.8	8.3	8.5	9.0	9.8

LED 舱顶灯
LED pendant light

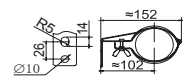
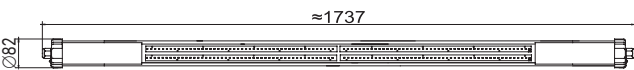
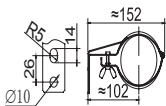

LZYC29/49

- **适用范围：**
该灯具适用于各类船舶有滴水、溅水和凝水（如露天甲板、机炉舱、干货舱、轴隧、管弄、外走道）等场所照明之用。
- **产品特性：**
1. 灯壳采用优质冷轧镀锌板拉伸成型，表面经过白色防酸环氧聚酯粉末喷涂处理。
2. 灯罩采用透明抗冲击聚碳酸脂注塑成型，灯罩密封圈采用发泡硅橡胶，密封性能良好。
3. 为保证用电安全，灯具内外均装有带“⊕”的接线桥架。
4. 采用 LED 光源，使用寿命长，光强度高，能耗低。
5. 电缆外径 Φ10 ~ Φ14mm。
- **采用标准及产品认证：**
1. 符合国际 IEC60598-1-2008 标准
2. 符合《钢质海船入级规范》
3. 通过中国船级社 (CCS) 型式认可。
4. 通过俄罗斯船级社 RMRS 型式认可证书。

- **The scope of application:**
This series of lights fit for illumination for the places of ships with water dripping,water spattering,water coagulating(such as weather place,such as oven cabin,dry cabin,tunnel,pipeline and weather deck etc.).
- **Products feature:**
1.The shell adopts good quality cold-rolled zinc galvanized plate by mold pressing ,Body surface is powder coated after anti-acid white.
2.The lampshade is made of transparent impact resistant poly carbonate plastic by injection forming, Lampshade seal-ring use foamed silicone rubber, with good sealed performance.
3.In order to ensure the safety of electricity, both inside and outside of lamps is equipped with "≡" connection bridge.
4.Adopt LED light source, long service life, high intensity, low energy consumption.
5.Cable outside diameter Φ10 ~ Φ14 mm.
- **Adopt standard and products certification:**
1.Conform to IEC60598-1-2008 INTERNATIONAL STANDARD.
2.Conform to GRADE ENTRY NORMS FOR STEEL SHIPS.
3.Approved by type approval of China Classification Society(CCS).
4.Approved by type approval of RMRS .

型号 TYPE	LZYC29-2	LZYC49-2
功率 (W) power	2X8W	2X16W
电压 / 频率 Voltage/frequency	AC100-240V 50/60HZ	
光源 Light source	LED 电源 +LED 灯条 LED Driver+ LED chips	
光通量 LM	1600LM	3200LM
防护等级 Protection class	IP66	
重 量 (Kg) Weight	3.7	5.0

LED 蓬顶灯
LED ceiling light

LED 蓬顶灯
LED ceiling light

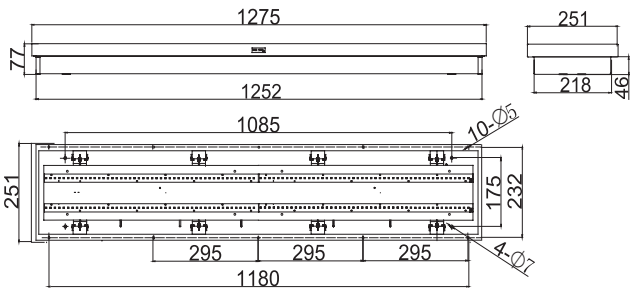
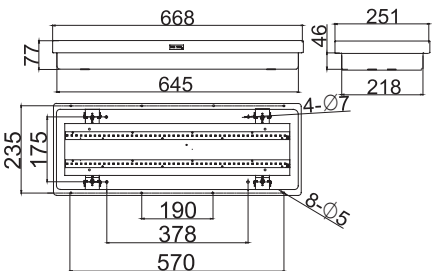

LZYP20/40

► 适用范围：

该灯具适用于各类船舶干燥舱室，如船员和旅客的居住舱、休息室、餐厅、驾驶室、报务室和内走道等场所照明之用。

► 产品特性：

1. 底壳采用优质冷轧镀锌板冲压成型，表面经过白色防酸环氧聚酯粉末喷涂处理。
2. 灯罩采用乳白色聚碳酸脂注塑成型，光线柔和。
3. 采用 LED 光源，使用寿命长，光强高，能耗低。
4. 灯具可配置 3W 应急 LED 光源，作为断电时临时照明。配置应急光源的灯具，其灯罩上带有小红点标志。
5. 灯罩与壳体用翻板弹簧固定，结构牢固。
6. 灯具安装方式为嵌入式。
7. 电缆外径 $\Phi 10 \sim \Phi 14\text{mm}$ 。

► 采用标准及产品认证：

1. 符合《钢质海船入级规范》。
2. 符合国际 IEC60598-1-2008 标准。
3. 通过中国船级社 (CCS) 型式认可。

► The scope of application:

The lamp is suitable for illumination for dry compartments of all types of vessels , such as living cabin crew and passengers, rest room, dinning room, cab, telegraph room and within the corridors and other places .

► Products feature:

- 1.The shell adopts good quality cold-rolled zinc galvanized plate by mold pressing ,Body surface is powder coated after anti-acid white.
- 2.Lampshade adopts milky white poly carbonate by injection molding with softness rays.
3. Adopt LED light source, long service life, high intensity, low energy consumption.
- 4.This light ca be equipped with 3W LED emergency light source, as temporary lighting when power off. With emergency lamp holder lights,on the lampshade with a red remark.
- 5.The lampshade and the shell are fixed with turn plate spring, with firm structure.
- 6.Mounting type: recessed type .
- 7.Cable outside diameter $\Phi 10 \sim \Phi 14\text{mm}$.

► Adopt standard and products certification:

- 1.Conform to GRADE ENTRY NORMS FOR STEEL SHIPS.
- 2.Conform to IEC60598-1-2008 INTERNATIONAL STANDARD.
- 3.Approved by type approval of China Classification

型号 Type	LZYP20-2	LZYP20-2E	LZYP20-2G	LZYP40-2	LZYP40-2E	LZYP40-2G
功率 (W)Power	2X8W	2X8W+3W	2X8W	2X16W	2X16W+3W	2X16W
电压 / 频率 Voltage/frequency	AC100-240V/50HZ ~ 60HZ					
光源 Light source	LED 电源 +LED 灯条 LED Driver+ LED chips					
光通量 lm	1300	1300	1300	2500	2500	2500
蓄电池放电时间 Battery emergency working time			$\geq 180\text{Min}$			$\geq 180\text{Min}$
重量 (Kg) Weight	4	4.2	5.5	7.5	7.7	9
防护等级 Protection class	IP44					

LED 蓬顶灯
LED ceiling light

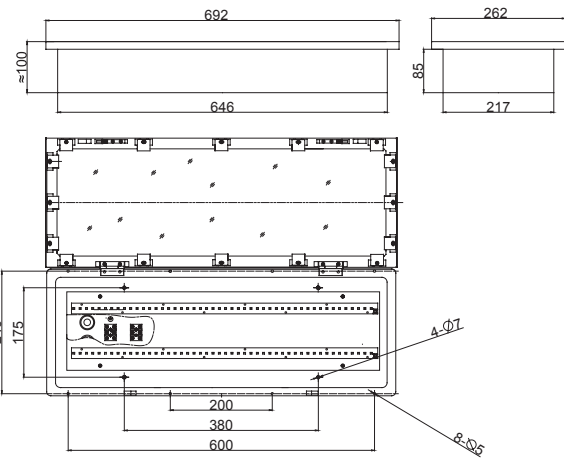

LZYP22-2

► 适用范围：

该灯具适用于各类船舶干燥舱室，如船员和旅客的居住舱、休息室、餐厅、驾驶室、报务室和内走道等场所照明之用。

► 产品特性：

1. 底壳采用优质冷轧镀锌板冲压成型，表面经过白色防酸环氧聚酯粉末喷涂处理。
2. 灯罩采用乳白色聚碳酸脂注塑成型，光线柔和。
3. 采用 LED 光源，使用寿命长，光强高，能耗低。
4. 灯具可配置 3W 应急 LED 光源，作为断电时临时照明。配置应急光源的灯具，其灯罩上带有小红点标志。
5. 灯具安装方式为嵌入式。
6. 电缆外径 $\Phi 10 \sim \Phi 14\text{mm}$ 。

► 采用标准及产品认证：

1. 符合《钢质海船入级规范》。
2. 符合国际 IEC60598-1-2008 标准。
3. 通过中国船级社 (CCS) 型式认可。

► The scope of application:

The lamp is suitable for illumination for dry compartments of all types of vessels , such as living cabin crew and passengers, rest room, dinning room, cab, telegraph room and within the corridors and other places .

► Products feature:

- 1.The shell adopts good quality cold-rolled zinc galvanized plate by mold pressing ,Body surface is powder coated after anti-acid white.
- 2.Lampshade adopts milky white poly carbonate by injection molding with softness rays.
3. Adopt LED light source, long service life, high intensity, low energy consumption.
- 4.This light ca be equipped with 3W LED emergency light source, as temporary lighting when power off. With emergency lamp holder lights,on the lampshade with a red remark.
- 5.Mounting type: recessed type .
- 6.Cable outside diameter $\Phi 10 \sim \Phi 14\text{mm}$.

► Adopt standard and products certification:

- 1.Conform to GRADE ENTRY NORMS FOR STEEL SHIPS.
- 2.Conform to IEC60598-1-2008 INTERNATIONAL STANDARD.
- 3.Approved by type approval of China Classification Society(CCS).

型号 Type	LZYP22-2	LZYP22-2E	LZYP22-2G
功率 (W)Power	2X8W	2X8W+3W	2X8W
电压 / 频率 Voltage/frequency	AC100-240V/50HZ ~ 60HZ		
光源 Light source	LED 电源 +LED 灯条 LED Driver+ LED chips		
光通量 lm	1200	1200	1200
蓄电池放电时间 Battery emergency working time			$\geq 180\text{Min}$
重量 (Kg) Weight	4.2	4.4	5.8
防护等级 Protection class	IP44		

LED 蓬顶灯
LED ceiling light

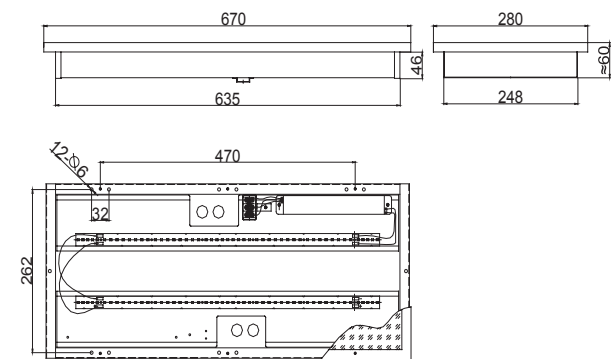

LZYP23-2

► 适用范围：

该灯具适用于各类船舶干燥舱室，如船员和旅客的居住舱、休息室、餐厅、驾驶室、报务室和内走道等场所照明之用。

► 产品特性：

1. 底壳采用优质冷轧镀锌板冲压成型，表面经过白色防酸环氧聚酯粉末喷涂处理。
2. 灯罩采用乳白色聚碳酸脂注塑成型，光线柔和。
3. 采用 LED 光源，使用寿命长，光强度高，能耗低。
4. 灯具可配置 3W 应急 LED 光源，作为断电时临时照明。配置应急光源的灯具，其灯罩上带有小红点标志。
5. 灯具安装方式为嵌入式。
6. 电缆外径 $\Phi 10 \sim \Phi 14\text{mm}$ 。

► 采用标准及产品认证：

1. 符合《钢质海船入级规范》。
2. 符合国际 IEC60598-1-2008 标准。

► The scope of application:

The lamp is suitable for illumination for dry compartments of all types of vessels , such as living cabin crew and passengers, rest room, dinning room, cab, telegraph room and within the corridors and other places .

► Products feature:

- 1.The shell adopts good quality cold-rolled zinc galvanized plate by mold pressing ,Body surface is powder coated after anti-acid white..
- 2.Lampshade adopts milky white poly carbonate by injection molding with softness rays.
3. Adopt LED light source, long service life, high intensity, low energy consumption.
- 4.This light ca be equipped with 3W LED emergency light source, as temporary lighting when power off. With emergency lamp holder lights,on the lampshade with a red remark.
- 5.Mounting type: recessed type .
- 6.Cable outside diameter $\Phi 10 \sim \Phi 14\text{mm}$.

► Adopt standard and products certification:

- 1.Conform to GRADE ENTRY NORMS FOR STEEL SHIPS.
- 2.Conform to IEC60598-1-2008 INTERNATIONAL STANDARD.

型号 Type	LZYP23-2	LZYP23-2E	LZYP23-2G
功率 (W)Power	2X8W	2X8W+3W	2X8W
电压 / 频率 Voltage/frequency	AC100-240V/50HZ ~ 60HZ		
光源 Light source	LED 电源 +LED 灯条 LED Driver+ LED chips		
光通量 lm	1200	1200	1200
蓄电池放电时间 Battery emergency working time			$\geq 180\text{Min}$
重量 (Kg) Weight	3.5	3.8	5.3
防护等级 Protection class	IP44		

LED 蓬顶灯
LED ceiling light

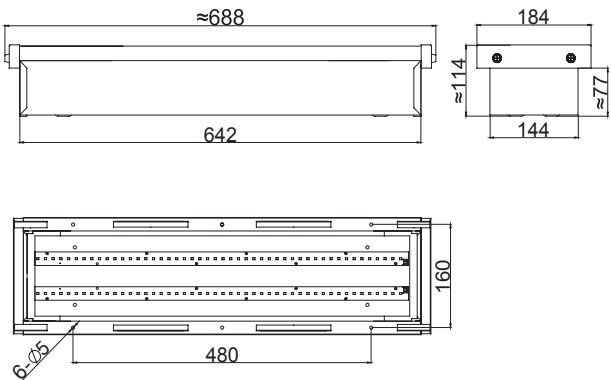

LZYP24-2

► 适用范围：

该灯具适用于各类船舶干燥舱室，如船员和旅客的居住舱、休息室、餐厅、驾驶室、报务室和内走道等场所照明之用。

► 产品特性：

1. 底壳采用优质冷轧镀锌板冲压成型，表面经过白色防酸环氧聚酯粉末喷涂处理。
2. 灯罩采用乳白色聚碳酸脂注塑成型，光线柔和。
3. 采用 LED 光源，使用寿命长，光强度高，能耗低。
4. 灯具可配置 3W 应急 LED 光源，作为断电时临时照明。配置应急光源的灯具，其灯罩上带有小红点标志。
5. 灯具安装方式为嵌入式。
6. 电缆外径 $\Phi 10 \sim \Phi 14\text{mm}$ 。

► 采用标准及产品认证：

1. 符合《钢质海船入级规范》。
2. 符合国际 IEC60598-1-2008 标准。
3. 通过中国船级社 (CCS) 型式认可。

► The scope of application:

The lamp is suitable for illumination for dry compartments of all types of vessels , such as living cabin crew and passengers, rest room, dinning room, cab, telegraph room and within the corridors and other places .

► Products feature:

- 1.The shell adopts good quality cold-rolled zinc galvanized plate by mold pressing ,Body surface is powder coated after anti-acid white.
- 2.Lampshade adopts milky white poly carbonate by injection molding with softness rays.
3. Adopt LED light source, long service life, high intensity, low energy consumption.
- 4.This light ca be equipped with 3W LED emergency light source, as temporary lighting when power off. With emergency lamp holder lights,on the lampshade with a red remark.
- 5.Mounting type: recessed type .
- 6.Cable outside diameter $\Phi 10 \sim \Phi 14\text{mm}$.

► Adopt standard and products certification:

- 1.Conform to GRADE ENTRY NORMS FOR STEEL SHIPS.
- 2.Conform to IEC60598-1-2008 INTERNATIONAL STANDARD.
- 3.Approved by type approval of China Classification Society(CCS).

型号 Type	LZYP24-2	LZYP24-2E	LZYP24-2G
功率 (W)Power	2X8W	2X8W+3W	2X8W
电压 / 频率 Voltage/frequency	AC100-240V/50HZ ~ 60HZ		
光源 Light source	LED 电源 +LED 灯条 LED Driver+ LED chips		
光通量 lm	1200	1200	1200
蓄电池放电时间 Battery emergency working time			$\geq 180\text{Min}$
重量 (Kg) Weight	3.8	4	5.3
防护等级 Protection class	IP22		

LED 蓬顶灯
LED ceiling light

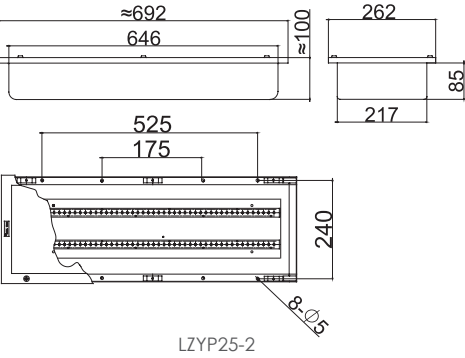

LZYP25-2

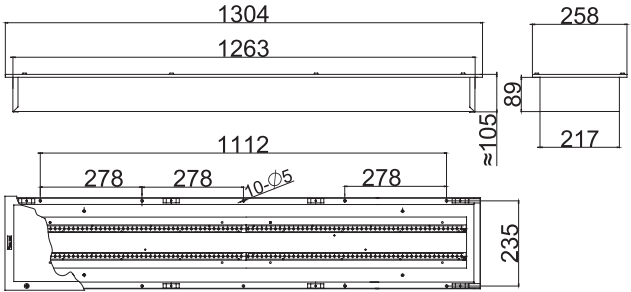

LZYP45-2

型号Type	LZYP25-2	LZYP25-2E	LZYP25-2G	LZYP45-2	LZYP45-2E	LZYP45-2G
功率(W)Power	2X8W	2X8W+3W	2X8W	2X16W	2X16W+3W	2X16W
电压/频率Voltage/frequency	AC100-240V/50HZ ~ 60HZ					
光源 Light source	LED电源+LED灯条 LED Driver+ LED chips					
光通量lm	1300	1300	1300	2500	2500	2500
蓄电池放电时间 Battery emergency working time			≥180Min		≥180Min	
重量 (Kg) Weight	4.2	4.4	5.8	7.8	8	9.5
防护等级Protection class	IP44					

► 适用范围:

该灯具适用于各类船舶干燥舱室，如船员和旅客的居住舱、休息室、餐厅、驾驶室、报务室和内走道等场所照明之用。

► 产品特性:

- 1.底壳采用优质冷轧镀锌板冲压成型，表面经过白色防酸环氧聚酯粉末喷涂处理。
- 2.灯罩采用乳白色聚碳酸脂注塑成型，光线柔和。
- 3.采用LED光源，使用寿命长，光强度高，能耗低。
- 4.灯具可配置3W应急LED光源，作为断电时临时照明。配置应急光源的灯具，其灯罩上带有小红点标志。
- 5.灯具安装方式为嵌入式。
- 6.电缆外径 $\Phi 10\sim\Phi 14\text{mm}$ 。

► 采用标准及产品认证:

- 1.符合《钢质海船入级规范》。
- 2.符合国际IEC60598-1-2008标准。
- 3.通过中国船级社(CCS)型式认可。

► The scope of application:

The lamp is suitable for illumination for dry compartments of all types of vessels , such as living cabin crew and passengers, rest room, dinning room, cab, telegraph room and within the corridors and other places .

► Products feature:

- 1.The shell adopts good quality cold-rolled zinc galvanized plate by mold pressing ,Body surface is powder coated after anti-acid white.
- 2.Lampshade adopts milky white poly carbonate by injection molding with softness rays.
3. Adopt LED light source, long service life, high intensity, low energy consumption.
- 4.This light ca be equipped with 3W LED emergency light source, as temporary lighting when power off. With emergency lamp holder lights,on the lampshade with a red remark.
- 5.Mounting type: recessed type .
- 6.Cable outside diameter $\Phi 10\sim\Phi 14\text{mm}$.

► Adopt standard and products certification:

- 1.Conform to GRADE ENTRY NORMS FOR STEEL SHIPS.
- 2.Conform to IEC60598-1-2008 INTERNATIONAL STANDARD.
- 3.Approved by type approval of China Classification Society(CCS).

LED 蓬顶灯
LED ceiling light

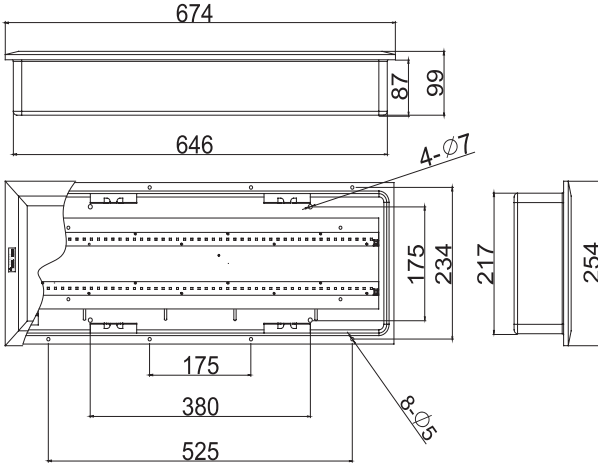

LZYP26-2

► 适用范围:

该灯具适用于各类船舶干燥舱室，如船员和旅客的居住舱、休息室、餐厅、驾驶室、报务室和内走道等场所照明之用。

► 产品特性:

- 1.底壳采用优质冷轧镀锌板冲压成型，灯盖采用铝合金拼接成型，表面经过白色防酸环氧聚酯粉末喷涂处理。
- 2.灯罩采用乳白色聚碳酸脂注塑成型，光线柔和。
- 3.采用LED光源，使用寿命长，光强度高，能耗低。
- 4.灯具可配置3W应急LED光源，作为断电时临时照明。配置应急光源的灯具，其灯罩上带有小红点标志。
- 5.灯具安装方式为嵌入式。
- 6.电缆外径 $\Phi 10\sim\Phi 14\text{mm}$ 。

► 采用标准及产品认证:

- 1.符合《钢质海船入级规范》。
- 2.符合国际IEC60598-1-2008标准。
- 3.通过中国船级社(CCS)型式认可。

► The scope of application:

The lamp is suitable for illumination for dry compartments of all types of vessels , such as living cabin crew and passengers, rest room, dinning room, cab, telegraph room and within the corridors and other places .

► Products feature:

- 1.The shell adopts good quality cold-rolled zinc galvanized plate by mold pressing ,light front frame adopts aliminium alloy connect .Body surface is powder coated after anti-acid white.
- 2.Lampshade adopts milky white poly carbonate by injection molding with softness rays.
3. Adopt LED light source, long service life, high intensity, low energy consumption.
- 4.This light ca be equipped with 3W LED emergency light source, as temporary lighting when power off. With emergency lamp holder lights,on the lampshade with a red remark.
- 5.Mounting type: recessed type .
- 6.Cable outside diameter $\Phi 10\sim\Phi 14\text{mm}$.

Adopt standard and products certification:

- 1.Conform to GRADE ENTRY NORMS FOR STEEL SHIPS.
- 2.Conform to IEC60598-1-2008 INTERNATIONAL STANDARD.
- 3.Approved by type approval of China Classification Society(CCS).

型号Type	LZYP26-2	LZYP26-2E	LZYP26-2G
功率(W)Power	2X8W	2X8W+3W	2X8W
电压/频率Voltage/frequency	AC100-240V/50HZ ~ 60HZ		
光源 Light source	LED电源+LED灯条 LED Driver+ LED chips		
光通量lm	1200	1200	1200
蓄电池放电时间 Battery emergency working time			≥180Min
重量 (Kg) Weight	4.8	5	6.5
防护等级Protection class	IP44		

LED 蓬顶灯
LED ceiling light

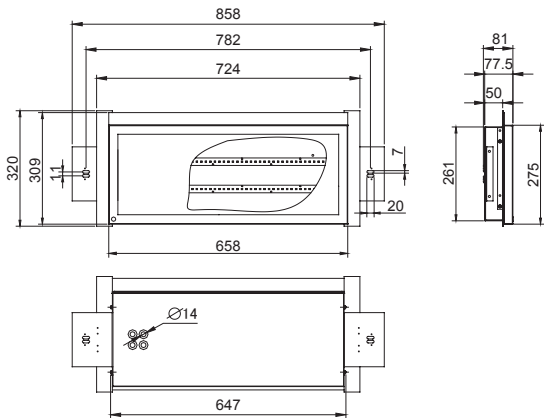

LZYP27-2 LZYP47-2

► 适用范围：

该灯具适用于各类船舶干燥舱室，如船员和旅客的居住舱、休息室、餐厅、驾驶室、报务室和内走道等场所照明之用。

► 产品特性：

1. 底壳采用优质冷轧镀锌板冲压成型，表面经过白色防酸环氧聚酯粉末喷涂处理。
2. 灯罩采用乳白色聚碳酸脂注塑成型，光线柔和。
3. 采用 LED 光源，使用寿命长，光强度高，能耗低。
4. 灯具可配置 3W 应急 LED 光源，作为断电时临时照明。配置应急光源的灯具，其灯罩上带有小红点标志。
5. 灯具安装方式为嵌入式。
6. 电缆外径 $\Phi 10 \sim \Phi 14\text{mm}$ 。

► 采用标准及产品认证：

1. 符合《钢质海船入级规范》。
2. 符合国际 IEC60598-1-2008 标准。
3. 通过中国船级社 (CCS) 型式认可。

► The scope of application:

The lamp is suitable for illumination for dry compartments of all types of vessels , such as living cabin crew and passengers, rest room, dinning room, cab, telegraph room and within the corridors and other places .

► Products feature:

- 1.The shell adopts good quality cold-rolled zinc galvanized plate by mold pressing ,Body surface is powder coated after anti-acid white.
- 2.Lampshade adopts milky white poly carbonate by injection molding with softness rays.
3. Adopt LED light source, long service life, high intensity, low energy consumption.
- 4.This light ca be equipped with 3W LED emergency light source, as temporary lighting when power off. With emergency lamp holder lights,on the lampshade with a red remark.
- 5.Mounting type: recessed type .
- 6.Cable outside diameter $\Phi 10 \sim \Phi 14\text{mm}$.

► Adopt standard and products certification:

- 1.Conform to GRADE ENTRY NORMS FOR STEEL SHIPS.
- 2.Conform to IEC60598-1-2008 INTERNATIONAL STANDARD.
- 3.Approved by type approval of China Classification Society(CCS).

型号 Type	LZYP27-2	LZYP27-2E	LZYP27-2G	LZYP47-2	LZYP47-2E	LZYP47-2G
功率 (W)Power	2X8W	2X8W+3W	2X8W	2X16W	2X16W+3W	2X16W
电压 / 频率 Voltage/frequency	AC100-240V/50HZ ~ 60HZ					
光源 Light source	LED 电源 +LED 灯条 LED Driver+ LED chips					
光通量 lm	1300	1300	1300	2500	2500	2500
蓄电池放电时间 Battery emergency working time			$\geq 180\text{Min}$			$\geq 180\text{Min}$
重量 (Kg) Weight	4	4.2	5.5	7.8	8	9.5
防护等级 Protection class	IP44					

LED 蓬顶灯
LED ceiling light

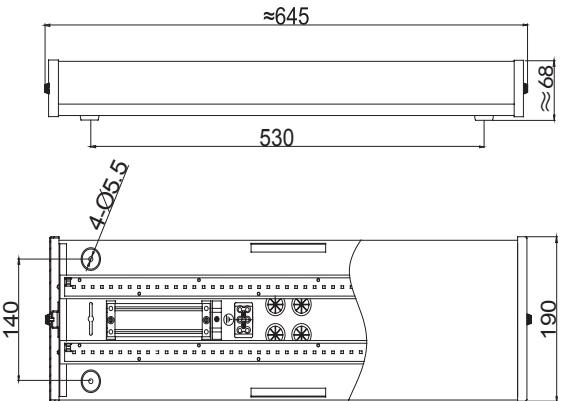

LZYP28-2

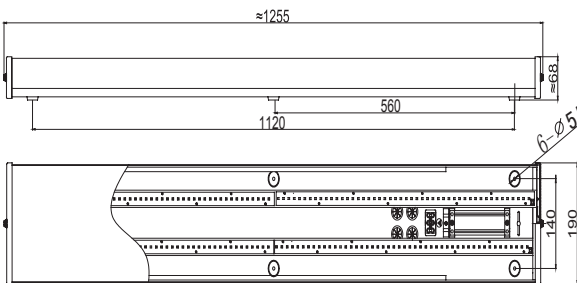

LZYP48-2

► 适用范围：

该灯具适用于各类船舶干燥舱室，如船员和旅客的居住舱、休息室、餐厅、驾驶室、报务室和内走道等场所照明之用。

► 产品特性：

1. 底壳采用优质冷轧镀锌板冲压成型，表面经过白色防酸环氧聚酯粉末喷涂处理。
2. 灯罩采用乳白色聚碳酸脂注塑成型，光线柔和。
3. 采用 LED 光源，使用寿命长，光强度高，能耗低。
4. 灯具可配置 3W 应急 LED 光源，作为断电时临时照明。配置应急光源的灯具，其灯罩上带有小红点标志。
5. 灯具安装方式为平面安装。
6. 电缆外径 $\Phi 10 \sim \Phi 14\text{mm}$ 。

► 采用标准及产品认证：

1. 符合《钢质海船入级规范》。
2. 符合国际 IEC60598-1-2008 标准。
3. 通过中国船级社 (CCS) 型式认可。

► The scope of application:

The lamp is suitable for illumination for dry compartments of all types of vessels , such as living cabin crew and passengers, rest room, dinning room, cab, telegraph room and within the corridors and other places .

► Products feature:

- 1.The shell adopts good quality cold-rolled zinc galvanized plate by mold pressing ,Body surface is powder coated after anti-acid white.
- 2.Lampshade adopts milky white poly carbonate by injection molding with softness rays.
3. Adopt LED light source, long service life, high intensity, low energy consumption.
- 4.This light ca be equipped with 3W LED emergency light source, as temporary lighting when power off. With emergency lamp holder lights,on the lampshade with a red remark.
- 5.Mounting type: surface mounting type .
- 6.Cable outside diameter $\Phi 10 \sim \Phi 14\text{mm}$.

► Adopt standard and products certification:

- 1.Conform to GRADE ENTRY NORMS FOR STEEL SHIPS.
- 2.Conform to IEC60598-1-2008 INTERNATIONAL STANDARD.
- 3.Approved by type approval of China Classification Society(CCS).

型号 Type	LZYP28-2	LZYP28-2E	LZYP28-2G	LZYP48-2	LZYP48-2E	LZYP48-2G
功率 (W)Power	2X8W	2X8W+3W	2X8W	2X16W	2X16W+3W	2X16W
电压 / 频率 Voltage/frequency	AC100-240V/50HZ ~ 60HZ					
光源 Light source	LED 电源 +LED 灯条 LED Driver+ LED chips					
光通量 lm	1300	1300	1300	2500	2500	2500
蓄电池放电时间 Battery emergency working time			$\geq 180\text{Min}$			$\geq 180\text{Min}$
重量 (Kg) Weight	4.2	4.5	5.8	7.3	7.5	9
防护等级 Protection class	IP22					

LED 蓬顶灯
LED ceiling light

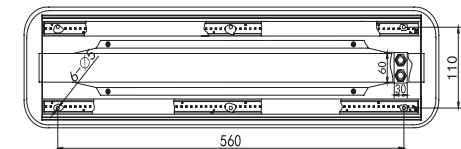
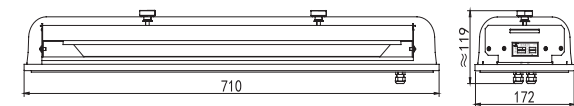

LZYP29-2

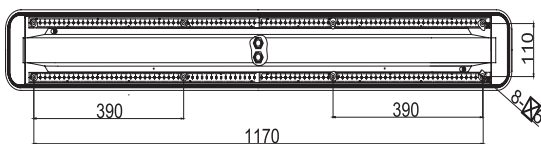
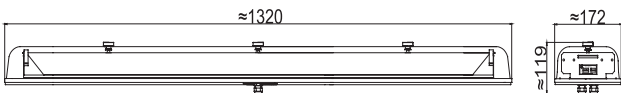

LZYP49-2

► 适用范围：

该灯具适用于各类船舶潮湿舱室，如厨房、和内走道等场所照明之用。

► 产品特性：

1. 底壳采用优质不锈钢板冲压成型。
2. 灯罩采用透明聚碳酸脂注塑成型，光线柔和。
3. 采用 LED 光源，使用寿命长，光强度高，能耗低。
4. 灯具可配置 3W 应急 LED 光源，作为断电时临时照明。
5. 灯具安装方式为平面安装。
6. 电缆外径 $\Phi 10 \sim \Phi 14\text{mm}$ 。

► 采用标准及产品认证：

1. 符合《钢质海船入级规范》。
2. 符合国际 IEC60598-1-2008 标准。
3. 通过中国船级社 (CCS) 型式认可。

► The scope of application:

Applied to the illumination for ships,for example wet cabin ,kitchen and side walk .

► Products feature:

- 1.The shell adopts good quality staineless steel by mold pressing.
- 2.Lampshade adopts transparent carbonate by injection molding with softness rays.
3. Adopt LED light source, long service life, high intensity, low energy consumption.
- 4.Equipped with 3W LED emergency light source, as temporary lighting when power off. With emergency lamp holder lights,on the lampshade with a red remark.
- 5.Mounting type: surface mounting type .
- 6.Cable outside diameter $\Phi 10 \sim \Phi 14\text{mm}$.

► Adopt standard and products certification:

- 1.Conform to GRADE ENTRY NORMS FOR STEEL SHIPS.
- 2.Conform to IEC60598-1-2008 INTERNATIONAL STANDARD.
- 3.Approved by type approval of China Classification Society(CCS).

型号 Type	LZYP29-2	LZYP29-2E	LZYP49-2	LZYP49-2E
功率 (W)Power	2X8W	2X8W+3W	2X16W	2X16W+3W
电压 / 频率 Voltage/frequency	AC100-240V/50HZ ~ 60HZ			
光源 Light source	LED 电源 +LED 灯条 LED Driver+ LED chips			
光通量 lm	1300	1300	2500	2500
重量 (Kg) Weight	5.5	5.8	8.5	8.8
防护等级 Protection class	IP56			

LED 蓬顶灯
LED ceiling light

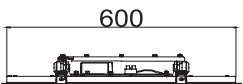
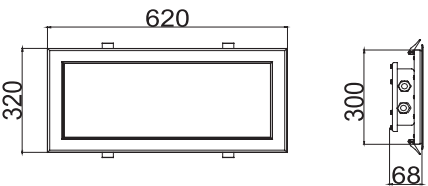

LZYP2620

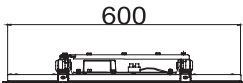
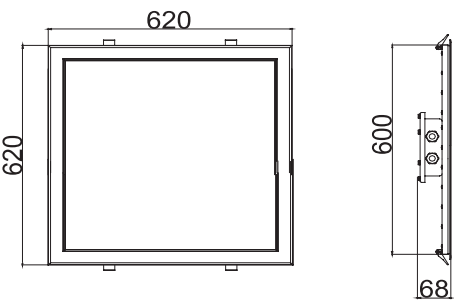

LZYP2640

► 适用范围：

该灯具适用于各类船舶干燥舱室，如船员和旅客的居住舱、休息室、餐厅、驾驶室、报务室和内走道等场所照明之用。

► 产品特性：

1. 底壳采用优质冷轧镀锌板冲压成型，灯盖采用铝合金拼接成型，表面经过白色防酸环氧树脂粉末喷涂处理。
2. 灯罩采用乳白色聚碳酸脂板材，光线柔和。
3. 采用 LED 光源，使用寿命长，光强度高，能耗低。
4. 灯具可另配置 5W 应急 LED 电源，当应急电路通电时，其中一根灯条亮，作为断电时应急照明。配置应急光源的灯具，其灯罩上带有小红点标志。
5. 灯具安装方式为嵌入式。
6. 电缆外径 $\Phi 10 \sim \Phi 14\text{mm}$ 。

► 采用标准及产品认证：

1. 符合《钢质海船入级规范》。
2. 符合国际 IEC60598-1-2008 标准。

► The scope of application:

The lamp is suitable for illumination for dry compartments of all types of vessels , such as living cabin crew and passengers, rest room, dinning room, cab, telegraph room and within the corridors and other places .

► Products feature:

- 1.The shell adopts good quality cold-rolled plate by mold pressing ,light front frame adopts aliminium alloy connect .Body surface is powder coated after anti-acid white.
- 2.Lampshade adopts milky white poly carbonate by injection molding with softness rays.
3. Adopt LED light source, long service life, high intensity, low energy consumption.
- 4.This light ca be equipped with 5W LED driver,as emergency lighting when power off. When the emergency circuit is switched on,one set chips will lighting.with emergency driver lights,on the diffuser with a red remark.
- 5.Mounting type: recessed type .
- 6.Cable outside diameter $\Phi 10 \sim \Phi 14\text{mm}$.

► Adopt standard and products certification:

- 1.Conform to GRADE ENTRY NORMS FOR STEEL SHIPS.
- 2.Conform to IEC60598-1-2008 INTERNATIONAL STANDARD.

型号 Type	LZYP2620	LZYP2620E	LZYP2640	LZYP2640E
功率 (W)Power	2X8W	2X8W+5W	4X8W	4X8W+5W
电压 / 频率 Voltage/frequency	AC100-240V/50HZ ~ 60HZ			
光源 Light source	LED 电源 +LED 灯条 LED Driver+ LED chips			
光通量 lm	1100	1100	2100	2100
重量 (Kg) Weight	4.2	5.1	8.2	9.2
防护等级 Protection class	IP44			

LED 筒灯
LED Barrel light

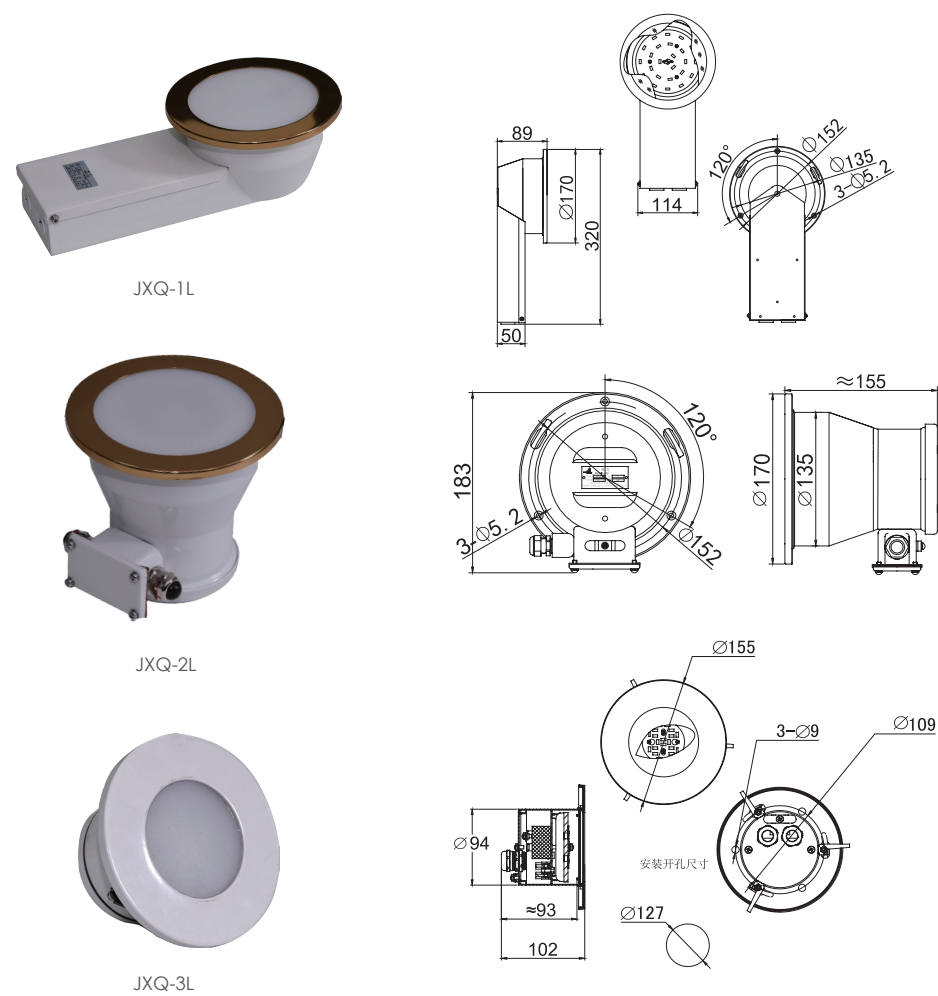

- **适用范围：**
该灯具适用于各类船舶的舱室作装饰照明。
- **产品特性：**
1. 灯体采用优质冷轧板模压成型。造型美观，光线柔和，嵌入式紧固件安装。
2.LED 光源，使用寿命长，光强高，能耗低。电缆外径： $\Phi 10 \sim \Phi 14\text{mm}$ 。
3. 可配置调光功能。
- **采用标准：**
符合 GB7000.201 标准；符合 GB7000.1 标准；符合《钢质海船入级规范》。

- **Range of application:**
This products is suitable for decoration illumination for cabin or all kinds of ships.
- **Products feature:**
1.The light body is made of cold-rolled zinc galvanized plate by mold pressing Beautiful shape, soft light, embedded fastener installation.designed,light softness and recessed mounting .
2.LED light source,long service life, high luminous intensity,and lower power consumption.Cable diameter: is $\Phi 10 \sim \Phi 14\text{mm}$.
3. It can equip with dimming function.
- **Adopt standard :**
Conform to STANDARD of GB7000.201, GB7000.1 and Conform to GRADE ENTRY NORMS FOR STEEL SHIPS.

型号 Type	JXQ-1L	JXQ-2L	JXQ-3L
电压 Voltage (V)	220V		
功率 Power(W)	10W	10W	5W
光源 Light source	LED 电源 +LED 光源 LED Driver+ LED chips		
防护等级 Protection class	IP22		IP44
重 量 Weight(Kg)	1..2	1.0	0.8

LED 角灯
LED Corner light

LED 镜前灯
LED Mirror light

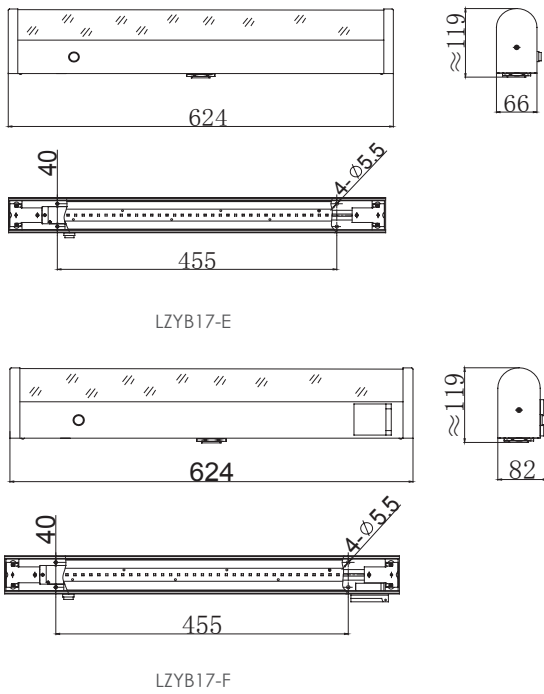

► 适用范围：

该灯具适用于各类船舶干燥舱室，如船员和旅客的居住舱、休息室、餐厅、驾驶室、报务室和内走道等场所照明和应急照明。

► 产品特性：

1. 灯具安装方式为墙壁式安装，结构紧凑，外观精致。
2. 灯壳采用优质冷轧镀锌板压制成型，表面经过白色防酸环氧聚酯粉末喷涂处理。
3. 灯罩采用乳白色聚碳酸脂注塑成型，不变色，韧性好，光线柔和及透光性好。
4. 采用 LED 光源，使用寿命长，光强度高，能耗低
5. 电缆外径 $\Phi 10 \sim \Phi 14\text{mm}$ 。

► 采用标准：

1. 符合国际 IEC60598-1-2008 标准。
2. 符合《钢质海船入级规范》。
3. 通过中国船级社 (CCS) 型式认可。

► The scope of application:

The lamp is suitable for illumination at dry compartments of all types of vessels , such as living cabin of crew and passengers, rest room, dinning room, cab, telegraph room and within the corridors and other places .

► Products feature:

1. Mounting type: wall type installation, compact structure, delicate appearance.
2. The shell adopts good quality cold-rolled Zinc galvanized plate welded ,surface is power coated after anti-acid white.
3. Lampshade adopts milky white poly carbonate by injection molding, non dis-coloring, good toughness, softness rays and good transparency.
4. Adopt LED light source, long service life, high intensity, low energy consumption.
5. Cable outside diameter $\Phi 10 \sim \Phi 14\text{mm}$.

► Adopt standard :

1. Conform to IEC60598-1-2008 INTERNATIONAL STANDARD.
2. Conform to GRADE ENTRY NORMS FOR STEEL SHIPS.
3. Approved by type approval of China Classification Society(CCS).

型号 Type	LZYB17-E	LZYB17-F
功率 (W) power	1X8W	1X8W
电压 / 频率 Voltage/frequency	AC100-240V 50/60HZ	
光源 Light source	LED 电源 +LED 灯条 LED Driver+ LED chips	
光通量 LM	680LM	680LM
防护等级 Protection class	IP34	
重 量 (Kg) Weight	2.3KGS	2.5KGS
备注 Remark	带开关 With switch	带开关插座 With switch and socket

LED 角灯
LED Wall light

► 适用范围：

该灯具适用于各类船舶干燥舱室，如船员和旅客的居住舱、休息室、餐厅、驾驶室、报务室和内走道等场所照明和应急照明。

► 产品特性：

1. 灯具安装方式为墙壁式安装，结构紧凑，外观精致。
2. 灯壳采用优质冷轧镀锌板压制成型，表面经过白色防酸环氧聚酯粉末喷涂处理。
3. 灯罩采用乳白色聚碳酸脂注塑成型，不变色，韧性好，光线柔和及透光性好。
4. 采用 LED 光源，使用寿命长，光强度高，能耗低
5. 灯具可配置 DC24V/3W 应急 LED 光源，作为断电时临时照明。配置应急光源的灯具，其灯罩上带有小红点标志。
6. 电缆外径 $\Phi 10 \sim \Phi 14\text{mm}$ 。

► 采用标准：

1. 符合国际 IEC60598-1-2008 标准。
2. 符合《钢质海船入级规范》。
3. 通过中国船级社 (CCS) 型式认可。

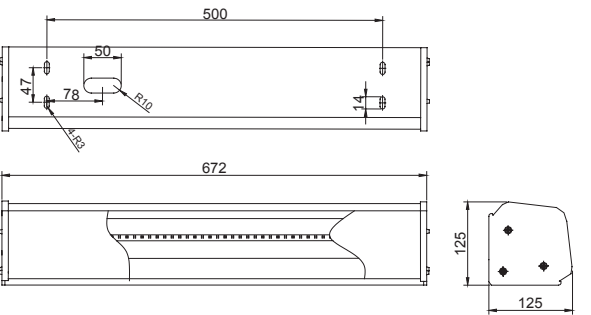

► The scope of application:

The lamp is suitable for illumination at dry compartments of all types of vessels , such as living cabin of crew and passengers, rest room, dinning room, cab, telegraph room and within the corridors and other places .

► Products feature:

1. Mounting type: wall type installation, compact structure, delicate appearance.
2. The shell adopts good quality cold-rolled Zinc galvanized plate welded ,Body surface is powder coated after anti-acid white.
3. Lampshade adopts milky white poly carbonate by injection molding, non dis-coloring, good toughness, softness rays and good transparency.
4. Adopt LED light source, long service life, high intensity, low energy consumption.
5. This light can be equipped with DC24V / 3W LED emergency light source, as temporary lighting when power off. With emergency lamp holder lights, on the lampshade with a red remark.
6. Cable outside diameter $\Phi 10 \sim \Phi 14\text{mm}$.

► Adopt standard :

1. Conform to IEC60598-1-2008 INTERNATIONAL STANDARD.
2. Conform to GRADE ENTRY NORMS FOR STEEL SHIPS.
3. Approved by type approval of China Classification Society(CCS).

型号 Type	LZYB20-1	LZYB20-1E
功率 (W) power	1X8W	1X8W+3W
电压 / 频率 Voltage/frequency	AC100-240V 50/60HZ	
光源 Light source	LED 电源 +LED 灯条 LED Driver+ LED chips	
光通量 LM	680LM	680LM
防护等级 Protection class	IP34	
重 量 (Kg) Weight	3.2KGS	3.5KGS

LED 角灯
LED Wall light

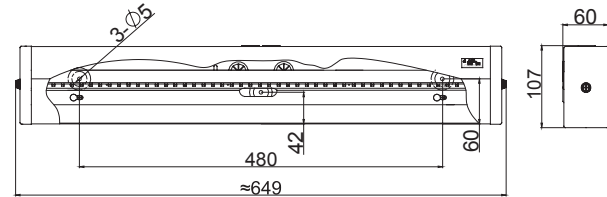

LZYB22-1/E

► 适用范围：

该灯具适用于各类船舶干燥舱室，如船员和旅客的居住舱、休息室、餐厅、驾驶室、报务室和内走道等场所照明和应急照明。

► 产品特性：

1. 灯具安装方式为墙壁式安装，结构紧凑，外观精致。
2. 灯壳采用优质冷轧镀锌板压制成型，表面经过白色防酸环氧聚酯粉末喷涂处理。
3. 灯罩采用乳白色聚碳酸酯注塑成型，不变色，韧性好，光线柔和及透光性好。
4. 采用 LED 光源，使用寿命长，光强度高，能耗低
5. 灯具可配置 3W 应急 LED 光源，作为断电时临时照明。配置应急光源的灯具，其灯罩上带有小红点标志。
6. 电缆外径 $\Phi 10 \sim \Phi 14\text{mm}$ 。

► 采用标准：

1. 符合国际 IEC60598-1-2008 标准。
2. 符合《钢质海船入级规范》。
3. 通过中国船级社 (CCS) 型式认可。

► The scope of application:

The lamp is suitable for illumination at dry compartments of all types of vessels , such as living cabin of crew and passengers, rest room, dinning room, cab, telegraph room and within the corridors and other places .

► Products feature:

- 1.Mounting type: wall type installation, compact structure, delicate appearance.
- 2.The shell adopts good quality cold-rolled Zinc galvanized plate welded ,Body surface is powder coated after anti-acid white.
- 3.Lampshade adopts milky white poly carbonate by injection molding, non dis-coloring, good toughness, softness rays and good transparency.
- 4.Adopt LED light source, long service life, high intensity, low energy consumption.
- 5.This light can be equipped with 3W LED emergency light source, as temporary lighting when power off. With emergency lamp holder lights,on the lampshade with a red remark.
- 6.Cable outside diameter $\Phi 10 \sim \Phi 14\text{mm}$.

► Adopt standard :

- 1.Conform to IEC60598-1-2008 INTERNATIONAL STANDARD.
- 2.Conform to GRADE ENTRY NORMS FOR STEEL SHIPS.
3. Approved by type approval of China Classification Society(CCS).

型号 Type	LZYB22-1	LZYB22-1E
功率 (W) power	1X8W	1X8W+3W
电压 / 频率 Voltage/frequency	AC100-240V 50/60HZ	
光源 Light source	LED 电源 +LED 灯条 LED Driver+ LED chips	
光通量 LM	680LM	680LM
防护等级 Protection class	IP34	
重 量 (Kg) Weight	2.5KGS	2.8KGS

LED 角灯
LED Wall light

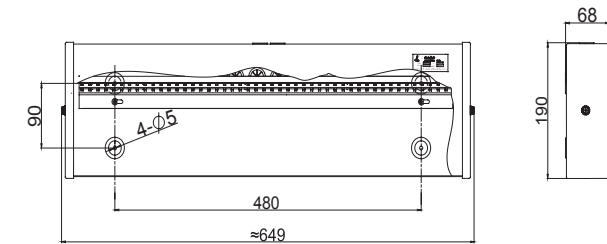

LZYB22-2/E

► 适用范围：

该灯具适用于各类船舶干燥舱室，如船员和旅客的居住舱、休息室、餐厅、驾驶室、报务室和内走道等场所照明和应急照明。

► 产品特性：

1. 灯具安装方式为墙壁式安装，结构紧凑，外观精致。
2. 灯壳采用优质冷轧镀锌板压制成型，表面经过白色防酸环氧聚酯粉末喷涂处理。
3. 灯罩采用乳白色聚碳酸酯注塑成型，不变色，韧性好，光线柔和及透光性好。
4. 采用 LED 光源，使用寿命长，光强度高，能耗低
5. 灯具可配置 3W 应急 LED 光源，作为断电时临时照明。配置应急光源的灯具，其灯罩上带有小红点标志。
6. 电缆外径 $\Phi 10 \sim \Phi 14\text{mm}$ 。

► 采用标准：

1. 符合国际 IEC60598-1-2008 标准。
2. 符合《钢质海船入级规范》。
3. 通过中国船级社 (CCS) 型式认可。

► The scope of application:

The lamp is suitable for illumination at dry compartments of all types of vessels , such as living cabin of crew and passengers, rest room, dinning room, cab, telegraph room and within the corridors and other places .

► Products feature:

- 1.Mounting type: wall type installation, compact structure, delicate appearance.
- 2.The shell adopts good quality cold-rolled Zinc galvanized plate welded ,Body surface is powder coated after anti-acid white.
- 3.Lampshade adopts milky white poly carbonate by injection molding, non dis-coloring, good toughness, softness rays and good transparency.
- 4.Adopt LED light source, long service life, high intensity, low energy consumption.
- 5.This light can be equipped with 3W LED emergency light source, as temporary lighting when power off. With emergency lamp holder lights,on the lampshade with a red remark.
- 6.Cable outside diameter $\Phi 10 \sim \Phi 14\text{mm}$.

► Adopt standard :

- 1.Conform to IEC60598-1-2008 INTERNATIONAL STANDARD.
- 2.Conform to GRADE ENTRY NORMS FOR STEEL SHIPS.
3. Approved by type approval of China Classification Society(CCS).

型号 Type	LZYB22-2	LZYB22-2E
功率 (W) power	2X8W	2X8W+3W
电压 / 频率 Voltage/frequency	AC100-240V 50/60HZ	
光源 Light source	LED 电源 +LED 灯条 LED Driver+ LED chips	
光通量 LM	1300LM	1300LM
防护等级 Protection class	IP34	
重 量 (Kg) Weight	3.0KGS	3.3KGS

LED 防爆灯

LED Explosion proof light

LED 防爆灯

LED Explosion proof light

- ▶ 适用范围:
- 适用于可能产生或积聚爆炸性气体混合物质，爆炸性气体环境为Ⅱ A、Ⅱ B、Ⅱ C,温度组别为T1 ~ T6 的舱室或露天场所作照明用。
- ▶ 产品特性:
1. 壳体采用优质铜材或不锈钢铸造成型，灯罩采用硬质硼砂玻璃，带铜质防护网罩。

2. 灯体采用的密封结构，具有良好的防水性能和防腐性能。

3.LED 光源，使用寿命长，光强度高，能耗低。

4. 灯具使用温度 -25℃~ +45℃。

5. 电缆外径 Φ9 ~ Φ12mm。
- ▶ 采用标准:
- 符合 GB3836.1-2010，GB3836.2-2010,IEC60079-0:2007，IEC60079-1:2007 等标准。



- ▶ The scope of application:
- Suitable for illumination for possible accumulation of explosive gas mixtures , explosive gas environment Ⅱ A, Ⅱ B, Ⅱ C, temperature class : T1 ~ T6 of cabin or open spaces.
- ▶ Products feature:
- 1.The shell adopts good quality cast brass or stainless steel,lampshade adopts hard borax glass,with stainless steel guard.

2.The lamp body adopts seal structure with high waterproof and corrosion resistance.

3.LED light source,long service life, high light intensity, low energy consumption.

4.The lamps can work normally under the temperature -25 ℃ ~ +45℃ .

5.Cable outside diameter Φ9 ~ Φ12mm.
- ▶ Adopt standard:
- Conform to GB3836.1-2010，GB3836.2-2010,IEC60079-0:2007，IEC60079-1:2007 standard.

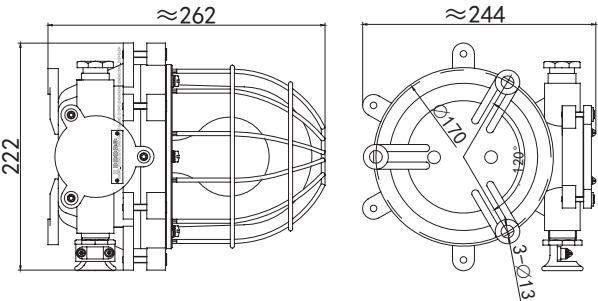

CFD2a

型号 Type	CFD2a
防爆标志 Explosion proof mark	Ex d Ⅱ CT6Gb
电压 Voltage (V)	24/220V
功率 Power(W)	≤ 18W
光源 Light source	LED 球泡 LED BULBS
防护等级 Protection class	IP66
重 量 Weight(Kg)	13.2KG

LED 防爆灯
LED Explosion proof light

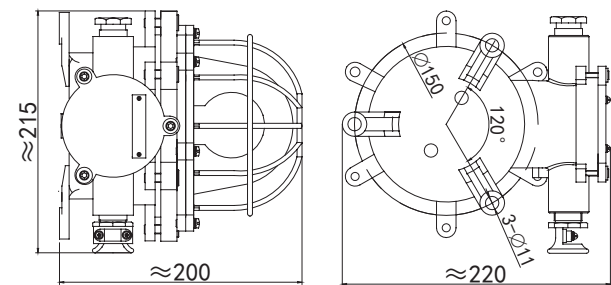

CFD3

► 适用范围:

适用于可能产生或积聚爆炸性气体混合物质, 爆炸性气体环境为 II A、II B、II C, 温度组别为 T1 ~ T6 的舱室或露天场所作照明用。

► 产品特性:

1. 壳体采用优质铜材或不锈钢铸造成型, 灯罩采用硬质硼砂玻璃, 带铜质防护网罩。
2. 灯体采用的密封结构, 具有良好的防水性能和防腐性能。
3. LED 光源, 使用寿命长, 光强度高, 能耗低。
4. 灯具使用温度 $-25^{\circ}\text{C} \sim +45^{\circ}\text{C}$ 。
5. 电缆外径 $\Phi 9 \sim \Phi 12 \text{ mm}$ 。

► 采用标准:

符合 GB3836.1-2010, GB3836.2-2010, IEC60079-0:2007, IEC60079-1:2007 等标准。

► The scope of application:

Suitable for illumination for possible accumulation of explosive gas mixtures, explosive gas environment II A, II B, II C, temperature class T1 ~ T6 of cabin or open spaces.

► Products feature:

1. The shell adopts good quality cast brass or stainless steel, lamp shade adopts hard borax glass, with stainless steel guard.
2. The lamp body adopts seal structure with high waterproof and corrosion resistance.
3. LED light source, long service life, high light intensity, low energy consumption.
4. The lamps can work normally under the temperature $-25^{\circ}\text{C} \sim +45^{\circ}\text{C}$.
4. Cable outside diameter $\Phi 9 \sim \Phi 12 \text{ mm}$.

► Adopt standard:

Conform to GB3836.1-2010, GB3836.2-2010, IEC60079-0:2007,

型号 Type	CFD3
防爆标志 Explosion proof mark	Ex d II CT6Gb
电压 Voltage (V)	24/220V
功率 Power(W)	≤ 13W
光源 Light source	LED 球泡 LED BULBS
防护等级 Protection class	IP66
重量 Weight(Kg)	10.2KG

LED 防爆灯
LED Explosion proof light

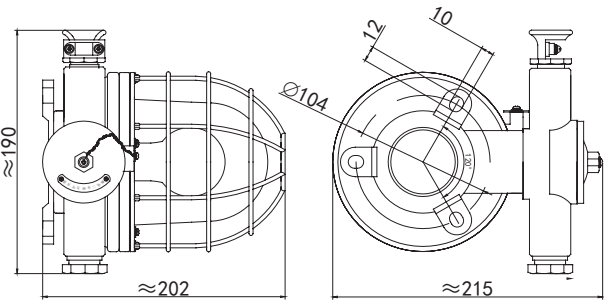

CFD5

► 适用范围:

适用于可能产生或积聚爆炸性气体混合物质, 爆炸性气体环境为 II A、II B、II C, 温度组别为 T1 ~ T6 的舱室或露天场所作照明用。

► 产品特性:

1. 壳体采用优质铜材或不锈钢铸造成型, 灯罩采用硬质硼砂玻璃, 带不锈钢防护网罩。
2. 灯体采用的密封结构, 具有良好的防水性能和防腐性能。
3. LED 光源, 使用寿命长, 光强度高, 能耗低。
4. 灯具使用温度 $-25^{\circ}\text{C} \sim +45^{\circ}\text{C}$ 。
5. 电缆外径 $\Phi 9 \sim \Phi 12 \text{ mm}$ 。

► 采用标准:

符合 GB3836.1-2010, GB3836.2-2010, IEC60079-0:2007, IEC60079-1:2007 等标准。

► The scope of application:

Suitable for illumination for possible accumulation of explosive gas mixtures, explosive gas environment II A, II B, II C, temperature class T1 ~ T6 of cabin or open spaces.

► Products feature:

1. The shell adopts good quality cast brass or stainless steel, lampshade adopts hard borax glass, with stainless steel guard.
2. The lamp body adopts seal structure with high waterproof and corrosion resistance.
3. LED light source, long service life, high light intensity, low energy consumption.
4. The lamps can work normally under the temperature $-25^{\circ}\text{C} \sim +45^{\circ}\text{C}$.
4. Cable outside diameter $\Phi 9 \sim \Phi 12 \text{ mm}$.

► Adopt standard:

Conform to GB3836.1-2010, GB3836.2-2010, IEC60079-0:2007,

型号 Type	CFD5
防爆标志 Explosion proof mark	Ex d II CT6Gb
电压 Voltage (V)	24/220V
功率 Power(W)	≤ 13W
光源 Light source	LED 球泡 LED BULBS
防护等级 Protection class	IP66
重量 Weight(Kg)	6.8KG

LED 防爆灯
LED Explosion proof light

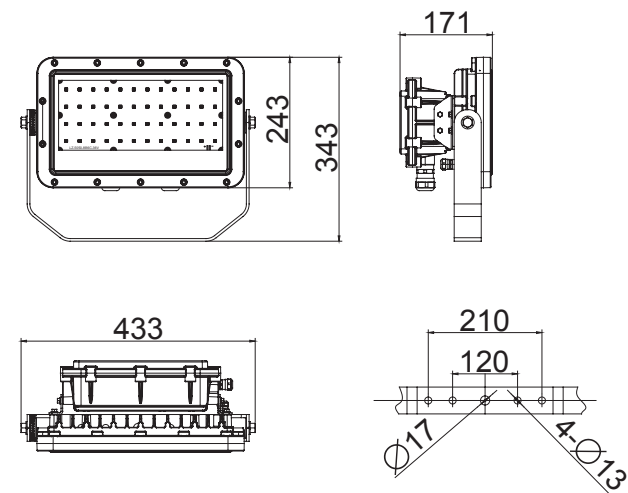

CFT3

型号 Type	CFT3
防爆标志 Explosion proof mark	Ex d II BT6 Gb
光源 Light source	LED 电源 +LED 光源模组 LED Driver+ LED chips
功率 Power(W)	150W
电压 Voltage (V)	220V50Hz/60Hz

- **适用范围:**
适用于船舶、石油开采平台、化工及爆炸性气体环境为 II B, 温度组别为 T1 ~ T6 的危险区域 1 区、2 区作照明或远距离照明用。
- **产品特性:**
1. 壳体采用优质铝材铸造成型, 灯罩采用硬质硼砂玻璃。
2. LED 光源, 使用寿命长, 光强度高, 能耗低。
3. 灯具使用环境温度 Ta -20℃ ~45℃。
4. 电缆外径 Φ10 ~ Φ14mm。
5. 灯具可安装水平旋转底座, 订货时需另行注明。水平旋转角度为 ±180° 垂直旋转角度 ±45° 。
- **采用标准:**
符合 GB3836.1-2010, GB3836.2-2010, IEC60079-0:2007, IEC60079-1:2007 等标准。

- **The scope of application:**
Applied to illumination for ship, oil exploit platform, chemical and explosive gas place II B, temperature class T1 ~ T6 dangerous places zone 1, zone 2.
- **Products feature:**
1. The shell adopts good quality cast aluminum, lampshade adopts hard borax glass.
2. LED light source, long service life, high light intensity, low energy consumption.
3. Ambient temperature Ta -20℃ ~45℃。
4. Cable outside diameter: Φ10 ~ Φ14mm.
5. The lamps can be installed on a horizontal rotating base plate. Please specify when ordering. The horizontal rotation Angle is ±180° and the vertical rotation Angle is ±45° 。
- **Adopt standard:**
Conform to GB3836.1-2010, GB3836.2-2010, IEC60079-0:2007, IEC60079-1:2007 standard.

LED 防爆灯
LED Explosion proof light

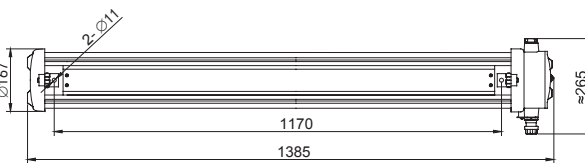
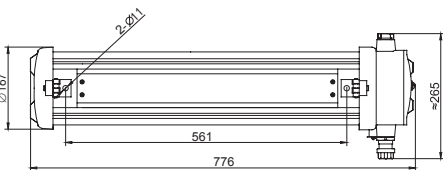
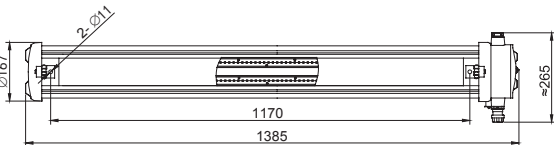
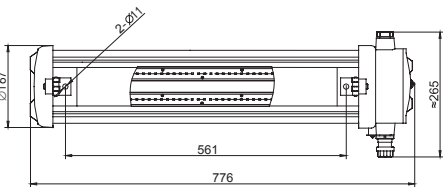
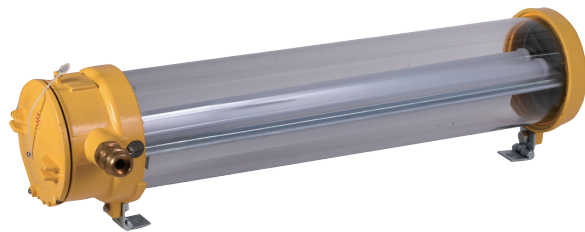

CFY20-2/40-2

- **适用范围:**
适用于船舶、石油开采平台、化工及爆炸性气体环境中危险区域 1 区、2 区, 可燃性气体、蒸汽级别为 II A、II B、II C 级, 温度组别为 T1 ~ T6 的危险场所作照明用。
- **产品特性:**
1. 壳体用优质铜材或不锈钢铸造成型, 灯体采用的密封结构, 具有良好的防水性能和防腐性能。
2. 安装方式为吊挂式。
3. LED 光源, 使用寿命长, 光强度高, 能耗低。
4. 电缆外径 Φ9 ~ Φ12mm。
5. 产品可带 DC24V 应急光源。
- **采用标准:**
符合 GB3836.1-2010, GB3836.2-2010, IEC60079-0:2007, IEC60079-1:2007 等标准。

- **The scope of application:**
Applied to illumination for ship, oil exploit platform, chemical and explosive gas place zone 1, zone 2, flammable gases, vapors level II A, II B, II C level, Temperature class T1 ~ T6 dangerous places.
- **Products feature:**
1. The shell adopts high quality cast brass or stainless steel, the lamp body adopts seal structure with high waterproof and corrosion resistance.
2. Mounting type: hanging
3. LED light source, long service life, high light intensity, low energy consumption.
4. Cable outside diameter: Φ9 ~ Φ12mm.
5. The lights can be equipped with 24V emergency light source.
- **Adopt standard:**
Conform to GB3836.1-2010, GB3836.2-2010, IEC60079-0:2007, IEC60079-1:2007 standard.

型号 Type	CFY20-2LT/ELT	CFY20-2LB/ELB	CFY40-2LT/ELT	CFY40-2LB/ELB
防爆标志 Explosion proof mark	Ex d II CT6Gb	Ex d II CT6Gb	Ex d II CT6Gb	Ex d II CT6Gb
电压 Voltage	220V50Hz /60Hz	220V50Hz /60Hz	220V50Hz /60Hz	220V50Hz /60Hz
功率 Power(W)	2X8W	20W	2X16W	40W
防护等级 Protection class	IP66	IP66	IP66	IP66
光源 Light source	LED 灯管 LED TUBE	LED 电源 +LED 灯条模组 LED Driver+ LED chips	LED 灯管 LED TUBE	LED 电源 +LED 灯条模组 LED Driver+ LED chips
重量 Weight(Kg)	12.2KG	13.3KG	17.1KG	18.2KG

LED 防爆灯
LED Explosion proof light

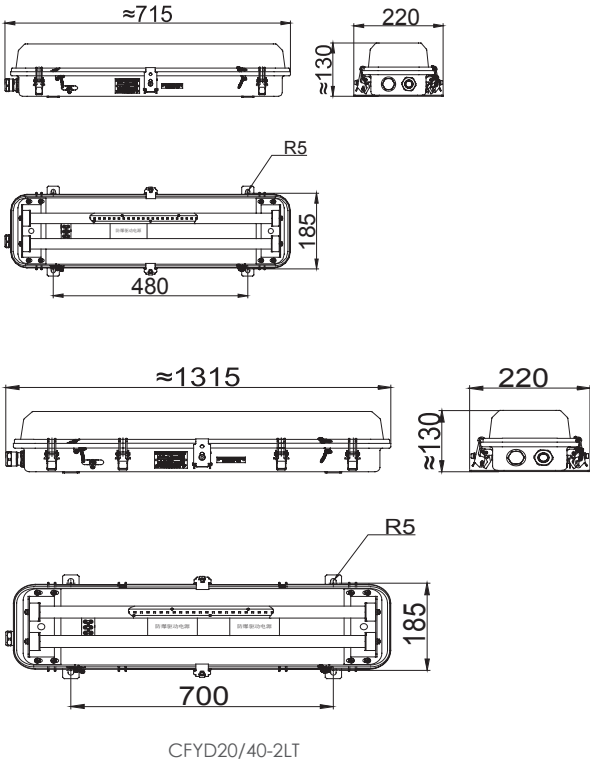

- **适用范围:**
适用于船舶、石油开采平台、化工及爆炸性气体环境中危险区域1区、2区，温度组别为T1～T6的爆炸危险场所中一般配电区域作照明使用。
- **产品特性:**
1、壳体采用优质钢材或不锈钢冲压成型，表面并作
2、喷塑处理。
3、灯罩选用抗冲击、耐腐蚀、耐热透明的
4、聚胺酸脂。
5、搭扣选用整体式结构，具有良好的防水
6、性能。
7、灯具安装方式为吊挂式或吸顶式。
8、灯具整体采用隔爆、增安型的防爆结构。
9、电缆外径 $\Phi 9 \sim \Phi 12$ mm。
- **采用标准:**
符合 GB3836.1-2010, GB3836.2-2010, GB3836.3-2010, GB3836.9-2014, IEC60079-0:2007, IEC60079-1:2007, IEC60079-7:2006, IEC60079-18:2009 等标准。

- **The scope of application:**
Applied to illumination for ship, oil exploit platform, chemical and explosive gas place zone 1, zone 2. Temperature class T1 ~ T6 explosion dangerous places in the general distribution area.
- **Products feature:**
1. The shell adopts good quality steel or stainless steel stamping molding, the surface of light is powder coated.
2. The lampshade is made of impact resistance, corrosion resistance, heat-resistant transparent amide acid ester.
3. Clips adopts integral type, with good waterproof performance
4. Mounting type: hanging or ceiling.
5. The whole light adopts flameproof type, increased safety type of explosion-proof structure.
6. Cable outside diameter: $\Phi 9 \sim \Phi 12$ mm.
- **Adopt standard:**
Conform to GB3836.1-2010, GB3836.2-2010, GB3836.3-2010, GB3836.9-2014, IEC60079-0:2007, IEC60079-1:2007, IEC60079-7:2006, IEC60079-18:2009 standard.

型号 Type	CFYD20-2LT	CFYD40-2LT
防爆标志 Explosion proof mark	Exd e mb II T6Gb	
电压 Voltage	220V50Hz/60Hz	
功率 Power(W)	20W	40W
防护等级 Protection class	IP66	
光源 Light source	LED 电源 +LED 灯条模组 LED Driver+ LED chips	
重量 Weight(Kg)	6.2	8.5

LED 投光灯
LED flood light

LED 投光灯
LED Flood light

LED 投光灯
LED flood light



LTG15-60

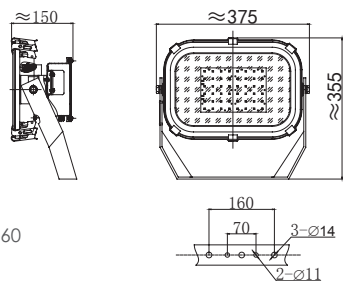

LTG15-100

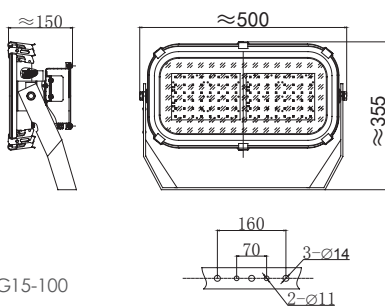

► 适用范围：

该灯具适用于港口及各类船舶露天甲板、货仓等大面积照射使用。

► 产品特性：

1. 灯壳采用优质不锈钢材模压成型。
2. 采用高光效的 LED 光源，具有超高亮度，耐热性能好，光衰小，品质性能稳定等特点。
3. 独特的鳍片式散热体设计，有效将热量传导扩散，散热效率高，从而降低灯体内的温度，保证了光源和电源的寿命。
- 4 采用特殊的表面处理工艺，外观美观新颖，安装简单，拆卸方便，适用范围广
5. 电缆外径 $\Phi 9 \sim \Phi 12\text{mm}$ 。

► 采用标准：

1. 符合国际 IEC60598-1-2014, IEC60598-2-5: 1998 标准
2. 符合《钢质海船入级规范》。

► The scope of application:

This light can be used in large places of all kinds of ships, ports, open deck of marine ship and cargo warehouse for illumination.

► Products feature:

- 1.The shell of light adopt good quality stainless steel material by compression molding.
- 2.Adopt high photosynthetic efficiency of LED light source, with high brightness and good heat resistant performance, light failure is small, stable quality performance etc.
- 3.Unique design of the fin type radiator body, with effectively conduct heat diffusion, high cooling efficiency, thereby reducing the lamp body temperature, ensure the service life of the light source and power supply.
- 4.The surface of light adopts special treatment technology,beautiful and novel appearance, simple installation, convenient dis-assembly, wide application scope.
- 5.Cable outside diameter: $\Phi 9 \sim \Phi 12\text{mm}$

► Adopt standard :

- 1.Conform to international standard of IEC60598-1-2014, IEC60598-2-5: 1998
- 2..Conform to GRADE ENTRY NORMS FOR STEEL SHIPS.

型号 Type	LTG15-60	LTG15-100
电压 / 频率 Voltage/frequency	100 ~ 240V/AC 50/60Hz	
LED 功率 Power (W)	60W	100W
光通量 (Lm) Luminous flux	550lm	900lm
相关色温 (K)Color Temperature	5000 ~ 6500K	
显色指数 Color Rendering Index	75	
光源使用寿命 Working Life-span (hrs)	> 50000h	
重量 (Kg)Weight	6.8KG	9.5KG
防护等级 Protection class	IP67	

► 适用范围：

该灯具适用于港口及各类船舶露天甲板、货仓等大面积照射使用。

► 产品特性：

1. 灯壳采用优质不锈钢材模压成型。
2. 采用高光效的 LED 光源，具有超高亮度，耐热性能好，光衰小，品质性能稳定等特点。
3. 独特的鳍片式散热体设计，有效将热量传导扩散，散热效率高，从而降低灯体内的温度，保证了光源和电源的寿命。
- 4 采用特殊的表面处理工艺，外观美观新颖，安装简单，拆卸方便，适用范围广
5. 电缆外径 $\Phi 9 \sim \Phi 12\text{mm}$ 。

► 采用标准：

1. 符合国际 IEC60598-1-2014, IEC60598-2-5: 1998 标准
2. 符合《钢质海船入级规范》。

► The scope of application:

This light can be used in large places of all kinds of ships, ports, open deck of marine ship and cargo warehouse for illumination.

► Products feature:

- 1.The shell of light adopt good quality stainless steel material by compression molding.
- 2.Adopt high photosynthetic efficiency of LED light source, with high brightness and good heat resistant performance, light failure is small, stable quality performance etc.
- 3.Unique design of the fin type radiator body, with effectively conduct heat diffusion, high cooling efficiency, thereby reducing the lamp body temperature, ensure the service life of the light source and power supply.
- 4.The surface of light adopts special treatment technology,beautiful and novel appearance, simple installation, convenient dis-assembly, wide application scope.
- 5.Cable outside diameter: $\Phi 9 \sim \Phi 12\text{mm}$.

► Adopt standard :

- 1.Conform to international standard of IEC60598-1-2014, IEC60598-2-5: 1998
- 2..Conform to GRADE ENTRY NORMS FOR STEEL SHIPS.

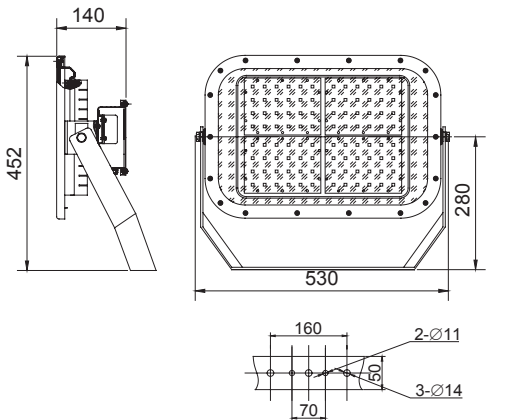
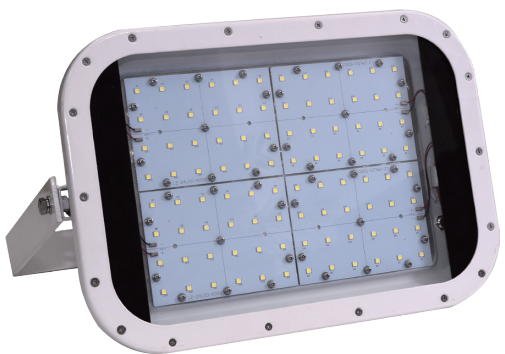

LTG15B-150/200

型号 Type	LTG15B-150	LTG15B-200
电压 / 频率 Voltage/frequency	100 ~ 240V/AC 50/60Hz	
LED 功率 Power (W)	150W	200W
光通量 (Lm) Luminous flux	1350lm	1800lm
相关色温 (K)Color Temperature	5000 ~ 6500K	
显色指数 Color Rendering Index	75	
光源使用寿命 Working Life-span (hrs)	> 50000h	
重量 (Kg)Weight	13.5KG	14.2KG
防护等级 Protection class	IP66	

LED 投光灯
LED Flood light

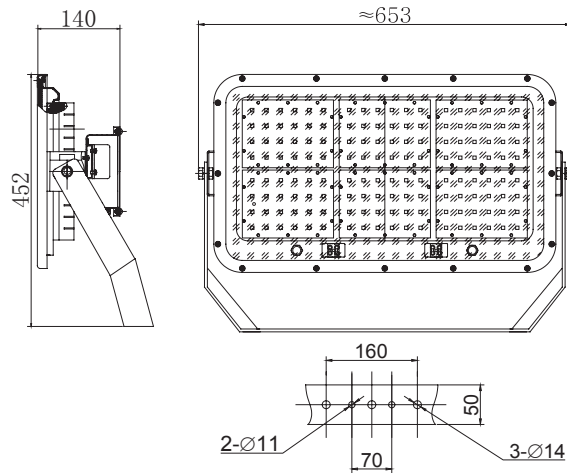
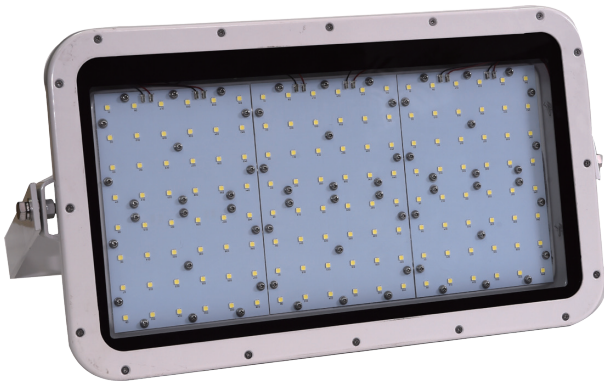

LTG15B-250/300

型号 Type	LTG15B-250	LTG15B-300
电压 / 频率 Voltage/frequency	100 ~ 240V/AC 50/60Hz	
LED 功率 Power (W)	250W	300W
光通量 (Lm) Luminous flux	2300lm	2800lm
相关色温 (K)Color Temperature	5000 ~ 6500K	
显色指数 Color Rendering Index	75	
光源使用寿命 Working Life-span (hrs)	> 50000h	
重量 (Kg)Weight	21.5KG	23KG
防护等级 Protection class	IP66	

► 适用范围：

该灯具适用于港口及各类船舶露天甲板、货仓等大面积照射使用。

► 产品特性：

1. 灯壳采用优质不锈钢材模压成型。
2. 采用高光效的 LED 光源，具有超高亮度，耐热性能好，光衰小，品质性能稳定等特点。
3. 独特的鳍片式散热体设计，有效将热量传导扩散，散热效率高，从而降低灯体内的温度，保证了光源和电源的寿命。
- 4 采用特殊的表面处理工艺，外观美观新颖，安装简单，拆卸方便，适用范围广。
5. 电缆外径 $\Phi 9 \sim \Phi 12\text{mm}$ 。

► 采用标准：

1. 符合国际 IEC60598-1-2014，IEC60598-2-5：1998 标准
2. 符合《钢质海船入级规范》

► The scope of application:

This light can be used in large places of all kinds of ships, ports, open deck of marine ship and cargo warehouse for illumination.

► Products feature:

- 1.The shell of light adopt good quality stainless steel material by compression molding.
- 2.Adopt high photosynthetic efficiency of LED light source, with high brightness and good heat resistant performance, light failure is small, stable quality performance etc.
- 3.Unique design of the fin type radiator body, with effectively conduct heat diffusion, high cooling efficiency, thereby reducing the lamp body temperature, ensure the service life of the light source and power supply.
- 4.The surface of light adopts special treatment technology, beautiful and novel appearance, simple installation, convenient dis-assembly, wide application scope.
- 5.Cable outside diameter: $\Phi 9 \sim \Phi 12\text{mm}$

► Adopt standard :

- 1.Conform to international standard of IEC60598-1-2014，IEC60598-2-5: 1998
- 2..Conform to GRADE ENTRY NORMS FOR STEEL SHIPS.

► 适用范围：

该灯具适用于港口及各类船舶露天场所做远距离投射照明或搜索搜救照明使用。

► 产品特性：

1. 灯壳采用优质不锈钢材模压成型。
2. 采用高光效的 LED 光源，具有超高亮度，耐热性能好，光衰小，品质性能稳定等特点。
3. 独特的鳍片式散热体设计，有效将热量传导扩散，散热效率高，从而降低灯体内的温度，保证了光源和电源的寿命。
- 4 采用特殊的表面处理工艺，外观美观新颖，安装简单，拆卸方便，适用范围广。
5. 电缆外径 $\Phi 9 \sim \Phi 12\text{mm}$ 。

► 采用标准：

1. 符合国际 IEC60598-1-2014，IEC60598-2-5：1998 标准
2. 符合《钢质海船入级规范》。

► The scope of application:

This light can be used in all kinds of ships as long distance and search lifesaving illumination , such as ports and open deck of marine ship .

► Products feature:

- 1.The shell of light adopt good quality stainless steel material by compression molding.
- 2.Adopt high photosynthetic efficiency of LED light source, with high brightness and good heat resistant performance, light failure is small, stable quality performance etc.
- 3.Unique design of the fin type radiator body, with effectively conduct heat diffusion, high cooling efficiency, thereby reducing the lamp body temperature, ensure the service life of the light source and power supply.
- 4.The surface of light adopts special treatment technology, beautiful and novel appearance, simple installation, convenient dis-assembly, wide application scope.
- 5.Cable outside diameter: $\Phi 9 \sim \Phi 12\text{mm}$

► Adopt standard :

- 1.Conform to international standard of IEC60598-1-2014，IEC60598-2-5: 1998
- 2..Conform to GRADE ENTRY NORMS FOR STEEL SHIPS.

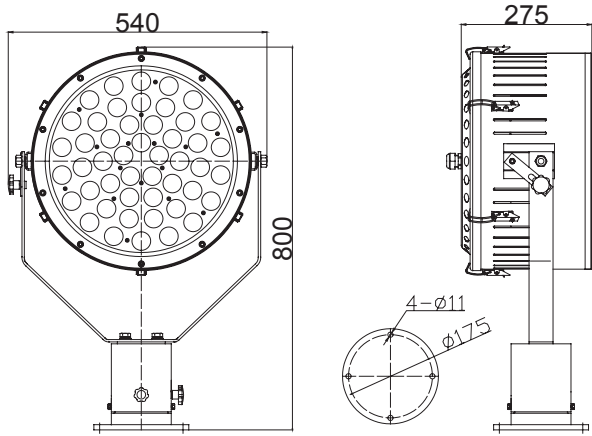

TZ4-300

型号 Type	TZ4-300
电压 / 频率 Voltage/frequency	100-240V/AC 50/60Hz
LED 功率 Power (W)	300W
LED 发光效率 Led Luminous Efficiency	120-130lm /W
LED 灯具初始光通量 Led Initial Flux	26500 Lm
灯具效率 lamp 's Efficiency	> 85%
照度均匀度 Illuminance Uniformity	> 0.8
相关色温 Color Temperature	5000K-6500K
显色指数 Color Rendering Index	Ra=70
配光方式 Light Design	LED+ 透镜 Lens
LED 结点温升 Junction Temperature	$\leq 60^{\circ}\text{C}$ (@Ta=30℃)
光源使用寿命 Working Life-span	> 50000h
重量 (Kg)Weight	40KG
防护等级 Protection class	IP56

LED 辅助照明
Auxiliary lighting

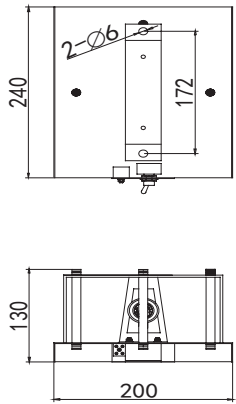

LED 壁灯 CBD2

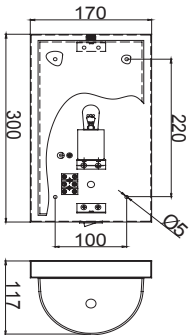

LED 壁灯 CBD4

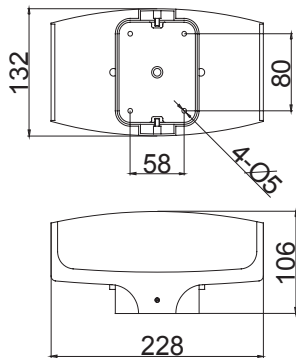

LED 壁灯 CBD5

- **适用范围：**
该灯具供各类船舶作辅助照明用。
- **产品特性：**
外观新颖，造型美观，光线柔和。壁式安装。
- **采用标准：**
1. 符合 GB7000.201 标准。
2. 符合 GB7000.1 标准。
3. 符合《钢质海船入级规范》

- **The scope of application:**
The lighting fit for auxiliary lighting for all types of ship .
- **Products feature:**
Novel appearance,nice shape,softness ray;Wall type mounting.
- **Adopt standard:**
1.Conform to GB7000.201 standard.
2.Conform to GB7000.1 standard.
3. Conform to GRADE ENTRY NORMS FOR STEEL SHIPS.

型号 Type	CBD2	CBD4	CBD5
电压 Voltage (V)	220V	220V	220V
灯座 Lamp holder	E27		LED 电源 +LED 光源 /18W LED Driver+ LED chips/18W
光源 / 功率 (W) Light source/Power	LED 球泡 /7W LED BULBS /7W	LED 球泡 /9W LED BULBS /9W	
材质 Material	不锈钢 Stainless steel	钢质 Steel	铝 Aluminum
重 量 Weight(Kg)	1.0	1.2	1.1

LED 辅助照明
Auxiliary lighting

LED 辅助照明
Auxiliary lighting



- 适用范围：
该灯具适用于各类船舶舱室内居住场所作床头照明用。
- 产品特性：
1. 旋转式遮光罩，根据需要可调节光照角度。
2. 采用 LED 球泡，寿命长，并且更换方便。
- 采用标准：
1. 符合国际 IEC60598-1-2008 标准。
2. 符合《钢质海船入级规范》

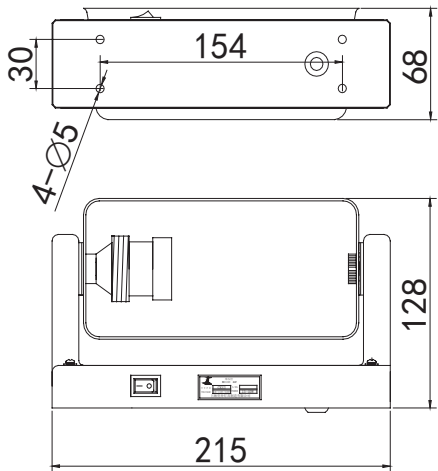

CKS3

- The scope of application:
This series products are designed as bedside lamp to use at the living room in ship cabin.
- Products feature:
1. Spin-type lens hood,can adjust the ray intensity according to requirement.
2. Adopt LED bulbs,long lifetime and easily to replace.
- Adopt standard:
1.Conform to STANDARD of IEC60598-1-2008.
2.Conform to GRADE ENTRY NORMS FOR STEEL SHIPS.

型号 TYPE	CKS3
功率 (W) power	7W
电压 Voltage	220/110/24
光源 Light source	LED bulbs
灯座 Lampholder	E27
防护等级 Protection class	IP20
重 量 (Kg) Weight	0.7KG



- 适用范围：
该灯具适用于船舶舱室内居住场所作床头照明。
- 产品特性：
1. 壳体采用优质 ABS 原料注塑成型，外观精致。
2. 采用 LED 光源，使用寿命长，光线柔和。
3. 具有分级调光功能。
4. 可调整发光角度。
5. 嵌入式安装方式。
- 采用标准及产品认证：
1. 符合《钢质海船入级规范》。
2. 符合国际 IEC60598-1-2008 标准。

- Range of application
This product is designed as bedside lamp to use at the living room in ship cabin
- Products feature:
1. The shell adopts high-quality ABS material injection molding, exquisite appearance
2.Adopt LED light source,long life service , soft light.
3.It has the function of grading and dimming.
4.Irritation angle can be adjusted.
5.Mounting type: recessed.
- Adopt standard and products certification:
1.Conform to GRADE ENTRY NORMS FOR STEEL SHIPS.
2.Conform to STANDARD of IEC60598-1-2008.

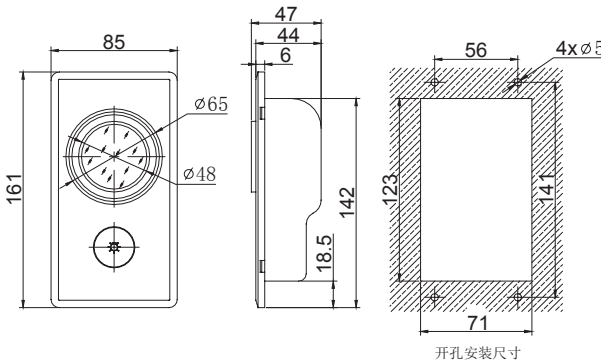

CKS4

型号 TYPE	CKS4
功率 (W) power	3W
电压 / 频率 Voltage/frequency	AC220-240V 50/60HZ
光源 Light source	LED 电源 +LED 光源 LED Driver+ LED chips
光通量 LM	250LM
防护等级 Protection class	IP34
重 量 (Kg) Weight	0.36KG

LED 辅助照明
Auxiliary lighting

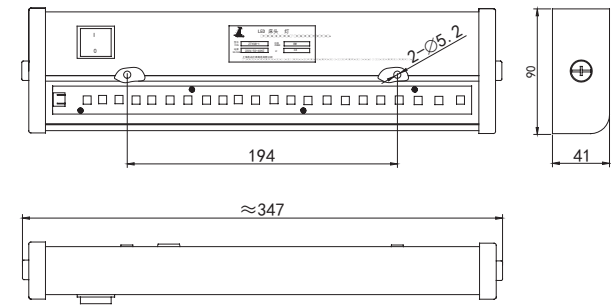

LZYT08-1

- **适用范围：**
该灯具适用于船舶舱室内居住场所作床头照明。
- **产品特性：**
1. 底壳采用优质冷轧镀锌板冲压成型，表面经过白色防酸环氧聚酯粉末喷涂处理。
2. 灯罩采用乳白色聚碳酸脂注塑成型，光线柔和。
3. 采用 LED 光源，使用寿命长，光强度高，能耗低。
4. 灯罩与底壳通过 ABS 端板和螺钉固定，外观精美，拆卸方便，易于维护。
5. 电缆外径 $\Phi 6 \sim \Phi 8\text{mm}$ 。
- **采用标准及产品认证：**
1. 符合《钢质海船入级规范》。
2. 符合国际 IEC60598-1-2008 标准。
3. 通过中国船级社 (CCS) 型式认可。
4. 通过俄罗斯船级社 RMRS 型式认可证书。

- **Range of application**
This product is designed as bedside lamp to use at the living room in ship cabin.
- **Products feature:**
1.The shell of light is made of good quality cold rolled Zinc galvanized steel sheets by compression molding, which surface was power coated and processed by white acid epoxy polyester powder.
2.The shade is made of milky poly carbonate by injection molding,with light softness.
3.LED light source,long service life, high light intensity, low energy consumption.
4.The shade and shell are fixed by ABS end plate and screws, elegant appearance, convenient dis-assembly, easy to maintain.
5.The diameter of cable is $\Phi 6 \sim \Phi 8\text{mm}$.
- **Adopt standard and products certification:**
1.Conform to GRADE ENTRY NORMS FOR STEEL SHIPS.
2.Conform to STANDARD of IEC60598-1-2008.
3.Approved by CHINA CLASSIFICATION SOCIETY(CCS).
4.Approved by type approval of RMRS .

型号 TYPE	LZYT08-1
功率 (W) power	5W
电压 / 频率 Voltage/frequency	AC100-240V 50/60HZ
光源 Light source	LED 电源 +LED 灯条 LED Driver+ LED chips
光通量 LM	350LM
防护等级 Protection class	IP34
重 量 (Kg) Weight	0.92KG
备注 Remark	带开关或带开关插座 With switch or with switch and socket

LED 辅助照明
Auxiliary lighting

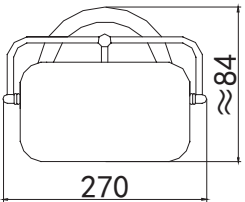
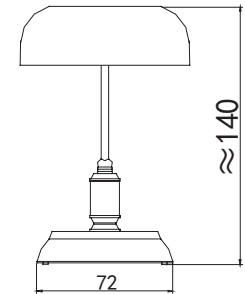

台灯 CTD3

- **适用范围：**
该类灯具适用于各类船舶舱室中工作台照明。
- **产品特性：**
附有橡胶自动吸盘，能自动固定在台面上。造型美观，光线柔和。
- **采用标准：**
符合 GB/T3852.8 标准；符合 GB7000.1 标准；符合《钢质海船入级规范》。
- **The scope of application:**
This series of light fit for the illumination of work table in cabin.
- **Products feature:**
With the rubber automatic suction cup,can fix it on the work table automatically. Nice shape,softness rays.
- **Adopt standard:**
Conform to GB/T3852.8 standard;Conform to GB7000.1 standard;
Conform to GRADE ENTRY NORMS FOR STEEL SHIPS.

型号 Type	CTD3
功率 (W) power	9W
电压 Voltage (V)	AC220V
光源 Light source	LED 球泡 LED BULBS
灯座 Lampholder	E27
材质 Material	钢质 Steel
色温 Temperature	军绿色 Green
重 量 Weight(Kg)	2.6KGS



- **适用范围：**
该类灯具适用于各类船舶舱室中工作台照明。
- **产品特性：**
1. 附有橡胶自动吸盘，能可靠固定在台面上。造型美观，光线柔和。
2.6 档触摸调光。
- **采用标准：**
符合 GB/T3852.8 标准；符合 GB7000.1 标准；符合《钢质海船入级规范》。

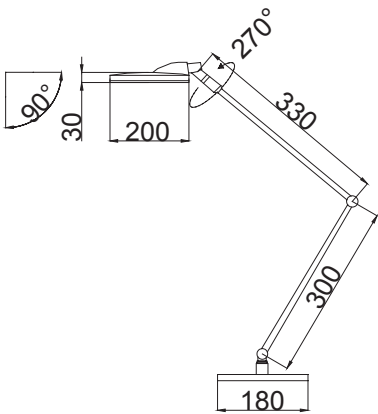

台灯 CTD8

- **The scope of application:**
This series of light fit for the illumination of work table in cabin.
- **Products feature:**
1. With rubber automatic chuck, can be reliably fixed on the table. Beautiful shape, soft light.
2. It has six Gear touch dimmer.
- **Adopt standard:**
Conform to GB/T3852.8 standard; Conform to GB7000.1 standard;
Conform to GRADE ENTRY NORMS FOR STEEL SHIPS.

型号 Type	CTD8
功率 (W) power	9W
电压 Voltage (V)	AC110-240V
光源 Light source	LED 光源 LED module
光通量 LM	450LM
材质 Material	电镀金属合金 Electroplated metal alloy
色温 Temperature	5500-6500K
重 量 Weight(Kg)	2.0KGS



- **适用范围：**
该类灯具适用于各类船舶舱室中工作台照明。
- **产品特性：**
1. 附有橡胶自动吸盘，能可靠固定在台面上。
2. 外壳采用优质 ABS 原料注塑成型。
3. 冷光，暖光切换选择。
4. 五级亮度调节，适应各种照明要求。
5. 数码管万年历时钟显示，带闹钟功能。
- **采用标准：**
符合 GB/T3852.8 标准；符合 GB7000.1 标准；符合《钢质海船入级规范》。

- **The scope of application:**
This series of light fit for the illumination of work table in cabin.
- **Products feature:**
1. With rubber automatic chuck, can be reliably fixed on the table.
2. The shell adopts high-quality ABS material injection molding,
3. White light, warm light switch selection.
4. Five - level brightness adjustment, adapt to various lighting requirements.
5. Digital tube calendar clock display, with alarm clock function.
- **Adopt standard:**
Conform to GB/T3852.8 standard; Conform to GB7000.1 standard;
Conform to GRADE ENTRY NORMS FOR STEEL SHIPS.

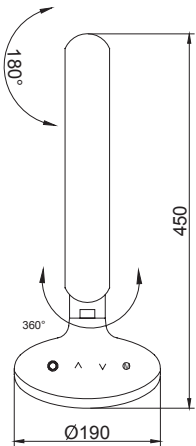

CTD9

型号 Type	CTD9
功率 (W) power	10W
电压 Voltage (V)	AC220V
光源 Light source	LED 光源 LED module
光通量 LM	450LM
材质 Material	ABS
色温 Temperature	冷光 white light 6000K 暖光 warm light 3300K
重 量 Weight(Kg)	1.2KGS